

# 22<sup>S</sup> SPRINT

1/10-SCALE 2WD ELECTRIC SPRINT CAR RTR

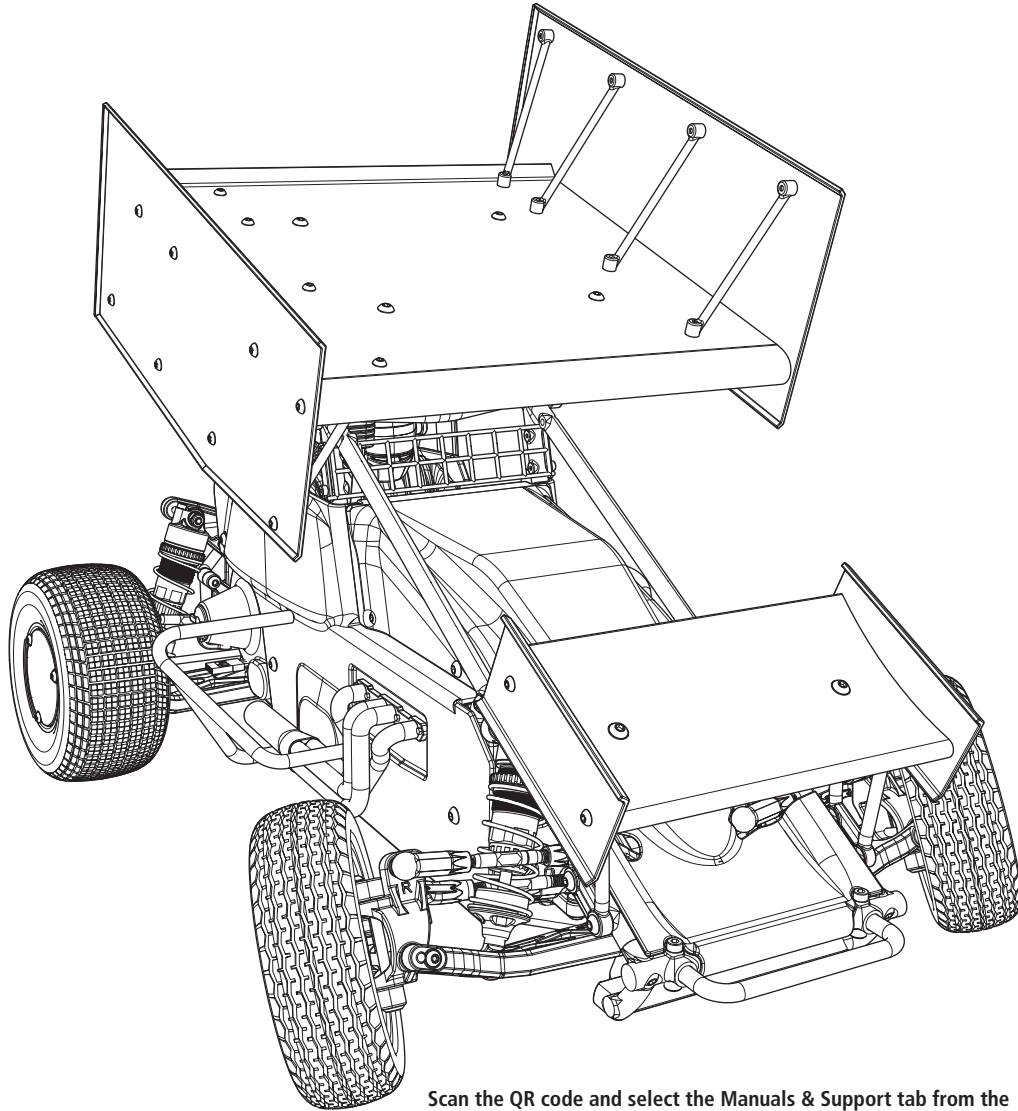

**INSTRUCTION MANUAL  
BEDIENUNGSANLEITUNG  
MANUEL D'UTILISATION  
MANUALE DI ISTRUZIONI**

Scan the QR code and select the Manuals & Support tab from the product page for the most up-to-date information.

Scannen Sie den QR-Code und wählen Sie auf der Produktseite die Registerkarte Handbücher und Unterstützung, um die aktuellsten Informationen zu erhalten.

Scannez le code QR et sélectionnez l'onglet Manuals and Support sur la page du produit pour obtenir les informations les plus récentes.

Scannerizzare il codice QR e selezionare la scheda Manuali e Supporto dalla pagina del prodotto per le informazioni più aggiornate.



LOS-1387 / LOS-2359

**NOTICE**

All instructions, warranties and other collateral documents are subject to change at the sole discretion of Horizon Hobby, LLC. For up-to-date product literature, visit [horizonhobby.com](http://horizonhobby.com) or [towerhobbies.com](http://towerhobbies.com) and click on the support or resources tab for this product.

**MEANING OF SPECIAL LANGUAGE**

The following terms are used throughout the product literature to indicate various levels of potential harm when operating this product:

**WARNING:** Procedures, which if not properly followed, create the probability of property damage, collateral damage, and serious injury OR create a high probability of superficial injury.

**CAUTION:** Procedures, which if not properly followed, create the probability of physical property damage AND a possibility of serious injury.

**NOTICE:** Procedures, which if not properly followed, create a possibility of physical property damage AND a little or no possibility of injury.

 **WARNING:** Read the ENTIRE instruction manual to become familiar with the features of the product before operating. Failure to operate the product correctly can result in damage to the product, personal property and cause serious injury. This is a sophisticated hobby product. It must be operated with caution and common sense and requires some basic mechanical ability. Failure to operate this Product in a safe and responsible manner could result in injury or damage to the product or other property. This product is not intended for use by children without direct adult supervision. Do not use with incompatible components or alter this product in any way outside of the instructions provided by Horizon Hobby, LLC. This manual contains instructions for safety, operation and maintenance. It is essential to read and follow all the instructions and warnings in the manual, prior to assembly, setup or use, in order to operate correctly and avoid damage or serious injury.

**Age Recommendation: Not for children under 14 years. This is not a toy.**

**SAFETY PRECAUTIONS AND WARNINGS**

As the user of this product, you are solely responsible for operating in a manner that does not endanger yourself and others or result in damage to the product or property of others.

This model is controlled by a radio signal subject to interference from many sources outside your control. This interference can cause momentary loss of control, so it is advisable to always keep a safe distance in all directions around your model as this margin will help avoid collisions or injury.

- Never operate your model with low transmitter batteries.
- Always operate your model in open spaces away from full-size vehicles, traffic and people.
- Never operate the model in the street or in populated areas for any reason.
- Carefully follow the directions and warnings for this and any optional support equipment (chargers, rechargeable battery packs, etc.) you use.
- Keep all chemicals, small parts and anything electrical out of the reach of children.
- Never lick or place any portion of the model in your mouth as it could cause serious injury or even death.
- Exercise caution when using tools and sharp instruments.
- Take care during maintenance as some parts may have sharp edges.
- Immediately after using your model, do NOT touch equipment such as the motor, electronic speed control and battery, because they generate high temperatures. You may burn yourself seriously touching them.
- Do not put fingers or any objects inside rotating and moving parts, as this may cause damage or serious injury.
- Always turn on your transmitter before you turn on the receiver in the car. Always turn off the receiver before turning your transmitter off.
- Keep the wheels of the model off the ground when checking the operation of the radio equipment.

 **WARNING AGAINST COUNTERFEIT PRODUCTS:** Always purchase from a Horizon Hobby, LLC authorized dealer to ensure authentic high-quality Spektrum product. Horizon Hobby, LLC disclaims all support and warranty with regards, but not limited to, compatibility and performance of counterfeit products or products claiming compatibility with DSM® or Spektrum technology.

## TABLE OF CONTENTS

Box Contents .....	3	After Your Run .....	11
Specifications .....	3	Changing to wingless .....	12
Required Equipment .....	3	Maintenance .....	13
Transmitter Functions .....	4	ESC Programming .....	17
Charging Warnings.....	5	Troubleshooting guide .....	18
Charge the vehicle battery .....	5	Limited Warranty .....	18
Install the Transmitter Batteries.....	6	Warranty and Service Contact Information.....	19
Remove the Body.....	6	FCC Information.....	20
Install the vehicle battery .....	7	IC Information.....	20
Power On the Transmitter.....	7	Compliance Information for the European Union.....	20
Power On the Vehicle.....	7	Exploded Views.....	78
Control Test.....	8	Replacement Parts .....	83
Driving .....	9	Recommended Parts.....	87
Battery Options.....	9	Optional Parts .....	87

## BOX CONTENTS

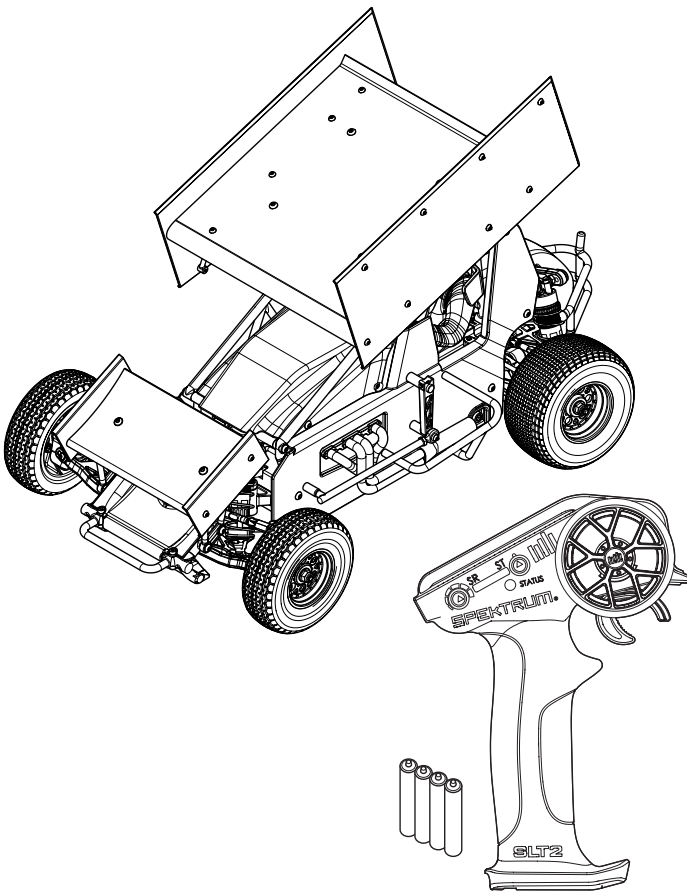

included with LOS-2359

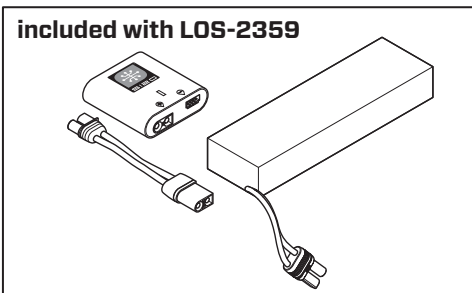

## SPECIFICATIONS

<b>Scale</b>	1/10
<b>Length</b>	17.1" (433mm)
<b>Width</b>	9.8" (249mm)
<b>Height</b>	12.1" (306mm)
<b>Weight</b>	4.62 lb (2.1kg) w/o battery
<b>Motor</b>	3300Kv, 4 pole, Sensorless Brushless
<b>ESC</b>	Firma 45 Brushless Smart Lite ESC
<b>Receiver</b>	Spektrum™ SLT 2CH Receiver
<b>Servo</b>	S684 25t Metal Gear Servo
<b>Transmitter</b>	SLT2 2-CH 2.4Ghz SLT (SPMRSLT200)
<b>Battery</b>	7.4V 4000mAh 2S 30C Smart LiPo G2 Hard Case: IC5 (included with LOS-2359)
<b>Charger</b>	S120 USB-C Smart Charger 1x20W (included with LOS-2359) or equivalent

## REQUIRED EQUIPMENT

**Battery:** 7.4V 5000mAh 2S 50C LiPo, IC5, G2 Smart Battery (included with LOS-2359), or 7.4V 4000mAh 2S 30C Smart LiPo G2 Hard Case: IC5

**Charger:** S155 55W AC G2 Smart Charger, S120 USB-C Smart Charger 1x20W (included with LOS-2359) or equivalent

### Tools:

- Shock Tools (included)
- Hex Drivers
  - 1.5mm
  - 2.0mm
- Nut Drivers
  - 5.5mm
  - 7.0mm

## TRANSMITTER FUNCTIONS

Use the diagram below to familiarize yourself with the different parts of your transmitter.

The transmitter antenna is mounted internally and is located in the front portion of the transmitter. When you are driving your model, hold the transmitter so it is oriented as close to vertical as possible. Do not try to follow your model with the transmitter. This provides the best RF signal between the transmitter and the receiver. Do not cover the front of the transmitter during use as doing so can block the RF signal, resulting in loss of control.

### SLT2 TRANSMITTER

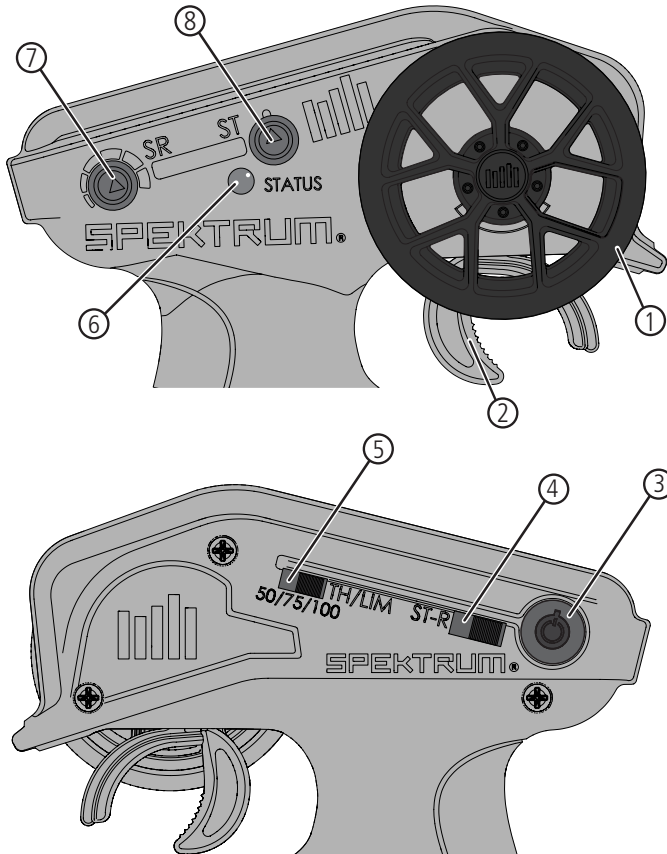

1. **Steering Wheel** Controls direction (left/right) of the model
2. **Throttle Trigger** Controls speed and direction (forward/brake/reverse) of the model
3. **Power Button** Turns the power on/off
4. **Steering (ST-R)** Servo Reversing Reverses the steering channel
5. **Throttle Limit** Limits throttle output to 50/75/100% Select 50% or 75% for less experienced drivers or when you are driving the vehicle in a small area
6. **Indicator Lights**
  - **Solid red light**—Indicates radio connectivity and adequate battery power
  - **Flashing red light**—Indicates the battery voltage is critically low. Replace the batteries
7. **Steering Rate** Adjusts the steering end points
8. **Steering Trim** Adjusts the steering center point

## CHARGING WARNINGS

**⚠ WARNING:** Failure to exercise caution while using this product and comply with the following warnings could result in product malfunction, electrical issues, excessive heat, FIRE, and ultimately injury and property damage.

- **NEVER LEAVE CHARGING BATTERIES UNATTENDED DURING USE.**
- **NEVER CHARGE BATTERIES OVERNIGHT.**
- The power supply must deliver power at Safety Extra Low Voltage (SELV).
- Never attempt to charge dead, damaged or wet battery packs.
- Never attempt to charge a battery pack containing different types of batteries.
- Never allow children under 14 years of age to charge battery packs.
- Never charge batteries in extremely hot or cold places or place in direct sunlight.
- Never charge a battery if the cable has been pinched or shorted.
- Never connect the charger if the power cable has been pinched or shorted.
- Never connect the charger to an automobile 12V battery while the vehicle is running.
- Never attempt to dismantle the charger or use a damaged charger.
- Never attach your charger to both an AC and a DC power source at the same time.
- Never connect the input jack (DC input) to AC power.
- Always use only rechargeable batteries designed for use with this type of charger in the correct programming mode.
- Always inspect the battery before charging.
- Always keep the battery away from any material that could be affected by heat.

- Always monitor the charging area and have a fire extinguisher available at all times. Always end the charging process if the battery becomes hot to the touch or starts to change form (swell) during the charge process.
- Always connect the charge cable to the charger first, then connect the battery to avoid short circuit between the charge leads. Reverse the sequence when disconnecting.
- Always connect the positive red leads (+) and negative black leads (-) correctly.
- Always disconnect the battery after charging, and let the charger cool between charges.
- Always charge in a well-ventilated area.
- Always terminate all processes and contact Horizon Hobby if the product malfunctions.
- Charge only rechargeable batteries. Charging non-rechargeable batteries may cause the batteries to burst, resulting in injury to persons and/or damage to property.
- The socket-outlet shall be installed near the equipment and shall be easily accessible.

**⚠ WARNING:** Never leave charger unattended, exceed maximum charge rate, charge with non-approved batteries or charge batteries in the wrong mode. Failure to comply may result in excessive heat, fire and serious injury.

**⚠ CAUTION:** Always ensure the battery you are charging meets the specifications of this charger and that the charger settings are correct. Not doing so can result in excessive heat and other related product malfunctions, which can lead to user injury or property damage. Please contact Horizon Hobby or an authorized retailer with compatibility questions.

## CHARGE THE VEHICLE BATTERY

Follow the manufacturer's directions for your charger to properly charge the vehicle battery.

**⚠ CAUTION:** Only use chargers designed to charge the chosen battery type. Using an incorrect charger or incorrect charger settings could cause the battery to catch fire or explode.

### OPERATING THE INCLUDED S120 SMART CHARGER (LOS-2359 ONLY)

1. Connect the S120 charger to a USB power supply adapter.
2. Connect the Smart battery lead to the IC5 to IC3 adapter.
3. Connect the IC3 adapter to the charge port on the S120 charger.

**TIP:** The battery can be disconnected from the charger at any time to stop the charging process.

4. Refer to the LED Indicator table for charger status.
5. A red LED will illuminate to indicate abnormal charging. Follow the operation steps to ensure proper connection is used to charge the battery.

**IMPORTANT:** Non-Smart batteries will cause the LED to illuminate red and the S120 will not recognize or charge the battery.

LED Indicator	
Power On – No Battery Connected	USB 5V/1A, 5V/2A: White LED USB Quick Charge 2.0/3.0: Blue LED
LiPo 2S and 3S Spektrum Smart Battery	<b>Battery Capacity</b> <b>Purple LED</b>
	Less Than 25%            Single Flash
	25% – 75%                Double Flash
76% – 99%                Triple Flash	
Charge Complete	Green LED (Solid)
Firmware Update	Red-Green-Blue Flashing LED
Error	Red LED (Solid)

1      Recommend: Spektrum 65W USB-C GaN Power Supply (SPMX-1027)

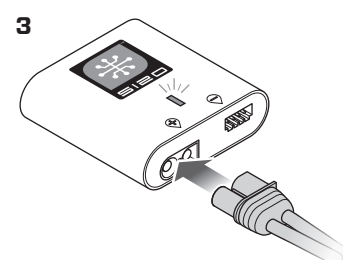
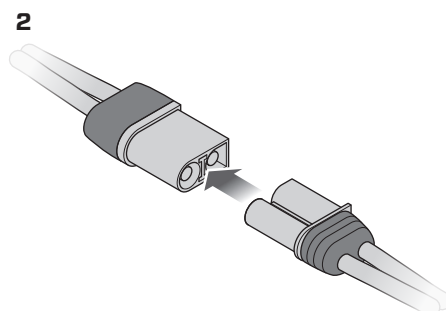
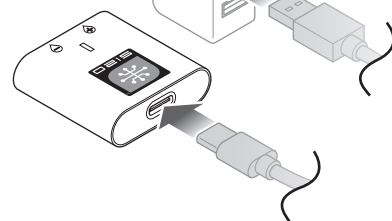

## INSTALL THE TRANSMITTER BATTERIES

This transmitter requires 4 AA batteries (included).

1. Remove the battery cover from the transmitter.
2. Install the batteries as shown.
3. Install the battery cover.

**⚠ CAUTION:** If using rechargeable batteries, charge only rechargeable batteries. Charging non-rechargeable batteries may cause the batteries to burst, resulting in injury to persons and/or damage to property.

**⚠ CAUTION:** Risk of explosion if battery is replaced by an incorrect type. Dispose of used batteries according to national regulations.

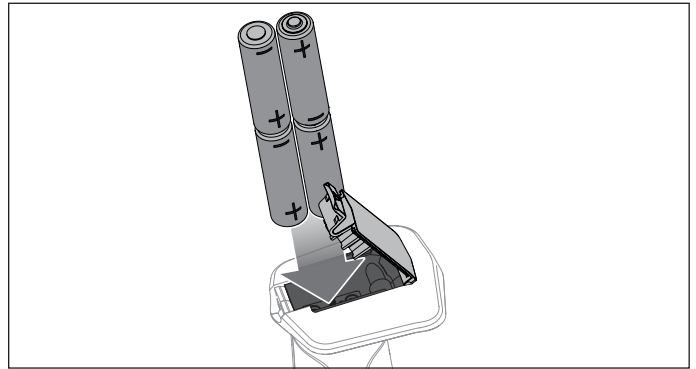

## REMOVE THE BODY

1. Pull back on the body latch.
- TIP:** Ensure the body latch is clean for easy operation.
2. Lift the rear of the body off the vehicle.

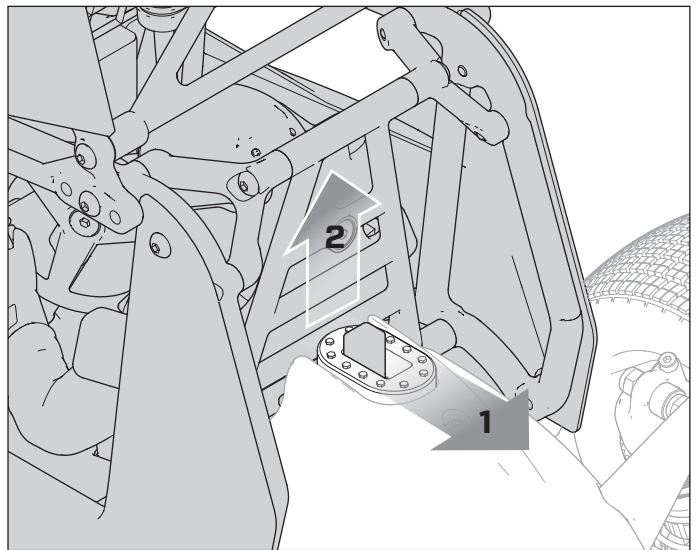

3. The body will pivot off the front latch and separate from the chassis.

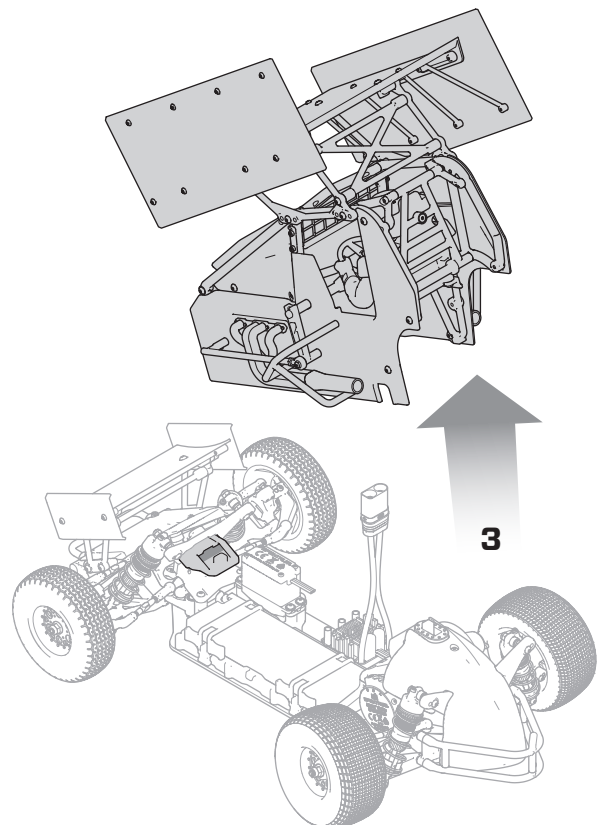

## INSTALL THE VEHICLE BATTERY

1. Unlock the elastomer battery straps.
2. Install the battery.
3. Connect the IC5 connector to the ESC.
4. Secure the battery with the elastomer straps.
5. Reinstall the body, insuring the body tab slides into the chassis locking slot. Connect the front first and then press down on the body on the rear to engage the latch.

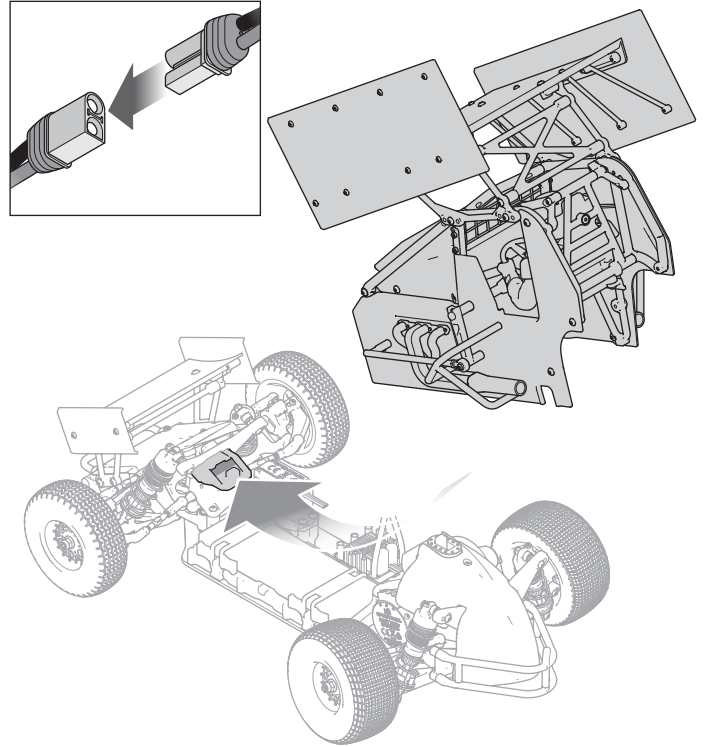

## POWER ON THE TRANSMITTER

To power on the transmitter press the power button located on the back of the transmitter, as shown.

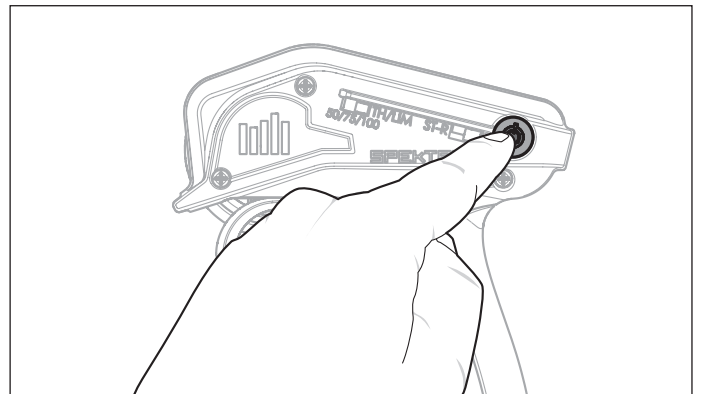

## POWER ON THE VEHICLE

Press the power button located on the left side of the vehicle, in front of the rear tire.

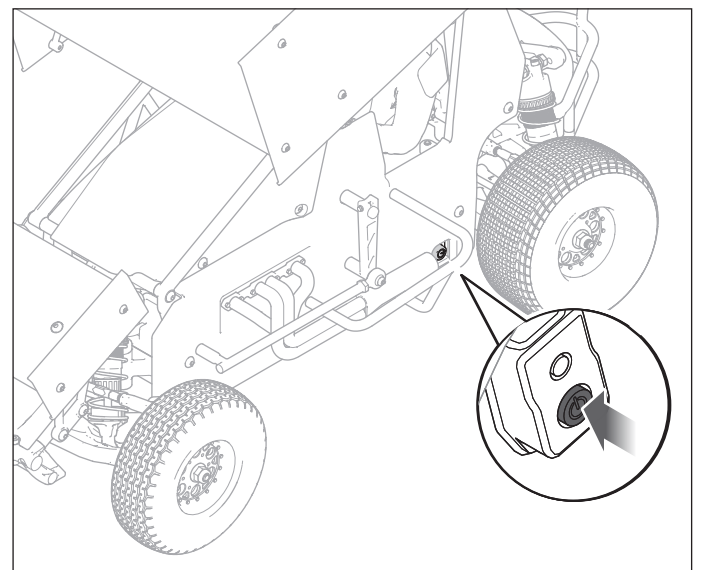

## CONTROL TEST

### THROTTLE AND BRAKE

Perform a control test with the vehicle wheels off the ground. To make the wheels move forward, pull the trigger. To reverse them, wait for the wheels to stop, then push the trigger.

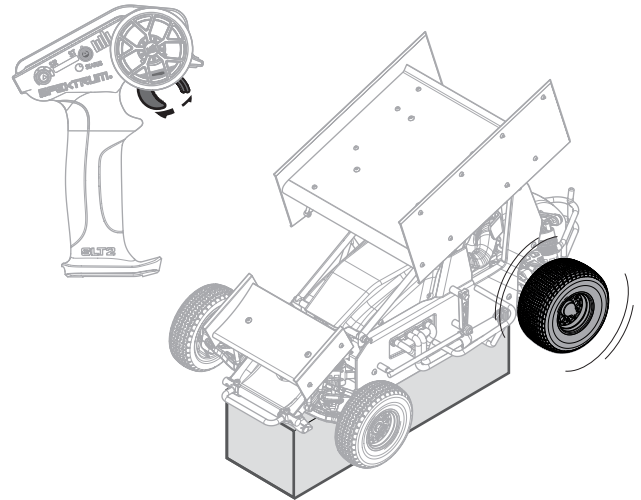

### STEERING

Move the steering wheel, the wheels will turn in response. When moving forward, the wheels should maintain a straight line without any steering wheel input. If not, adjust the Steering Trim, so the wheels maintain a straight line without having to turn the steering wheel.

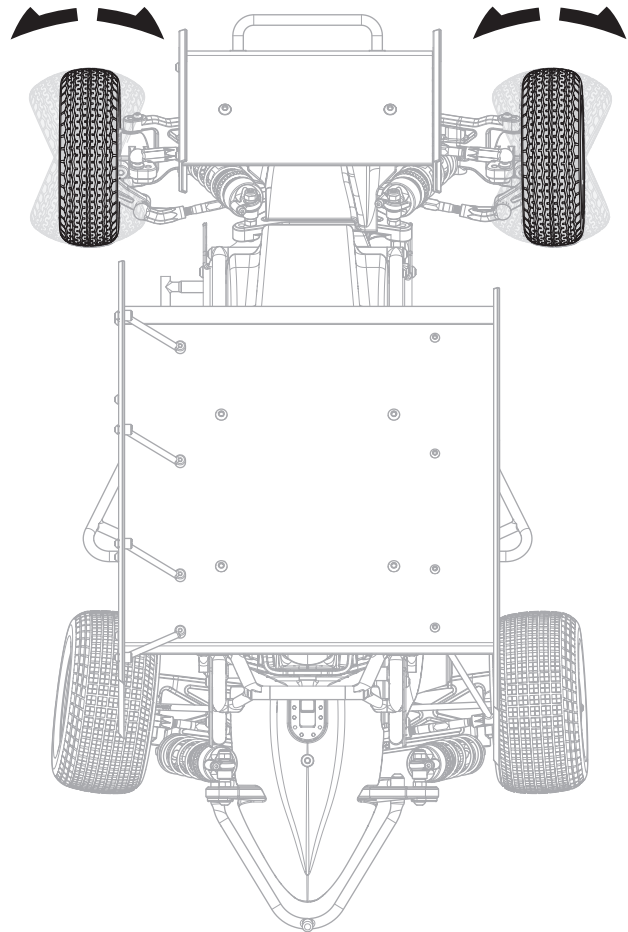
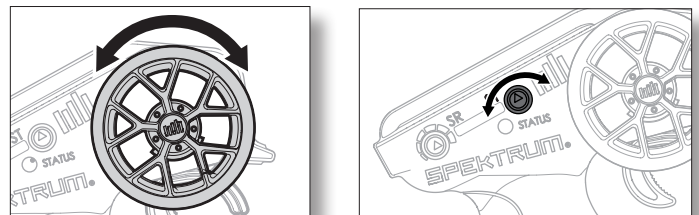

## DRIVING

### DRIVING PRECAUTIONS

- ALWAYS turn on your transmitter before you turn on the receiver in the vehicle. Always power off the receiver before turning your transmitter off.
- Maintain sight of the vehicle at all times.
- Inspect the vehicle for loose wheel hardware.
- Inspect the steering assembly for any loose hardware. Driving the vehicle off-road can cause fasteners to loosen over time.
- ALWAYS operate your vehicle in a wide open area. Operating the vehicle in a small space or indoors can cause overheating at low speeds. Operating at low speed increases heat in the electronic speed control (ESC). Overheating can damage the vehicle and failure may result.
- Do not drive the vehicle in tall grass. Doing so can damage the vehicle or electronics.
- Stop driving the vehicle when you notice a lack of power. Driving the vehicle when the battery is discharged can cause the receiver to power off. You may lose control of the vehicle.
- Do not apply the throttle forward or reverse if the vehicle is stuck. Applying throttle in this instance can damage the motor or ESC.
- After driving the vehicle, allow the electronics to cool to ambient temperature before using the next battery pack.

### RUN TIME

Average run times is approximately 13-15 minutes with the included 4000 mAh Spektrum 2s LiPo battery (LOS-2359 Only). With the recommended 2S 5000mAh battery pack average run times approximately 17-19 minutes. The condition of a battery pack is also an important factor in both run time and speed. The battery connectors may become hot during driving. Batteries will lose performance and capacity over time.

Driving the vehicle from a stop to full speed repeatedly will damage the batteries and electronics over time. Sudden acceleration will also lead to shorter run times.

### TO IMPROVE RUN TIMES

- Keep your vehicle clean and well maintained.
- Allow more airflow to the ESC and motor.
- Change the gearing to a lower ratio. A lower ratio lowers the operating temperature of the electronics. Use a smaller pinion gear or larger spur gear to lower the gear ratio.

## BATTERY OPTIONS

### BATTERY STRAPS

Optional battery straps are included to accommodate different size batteries.

If you are planning to use a "Slim" LiPo battery, install the included small elastomer battery straps using the directions below.

To change the battery straps:

1. Use a 2mm hex driver to remove battery strap retainer.
2. Remove the pivot pins from the battery straps from the vehicle.
3. Insert the pivot pin into the new battery strap
4. Reassemble the battery straps and retainers.

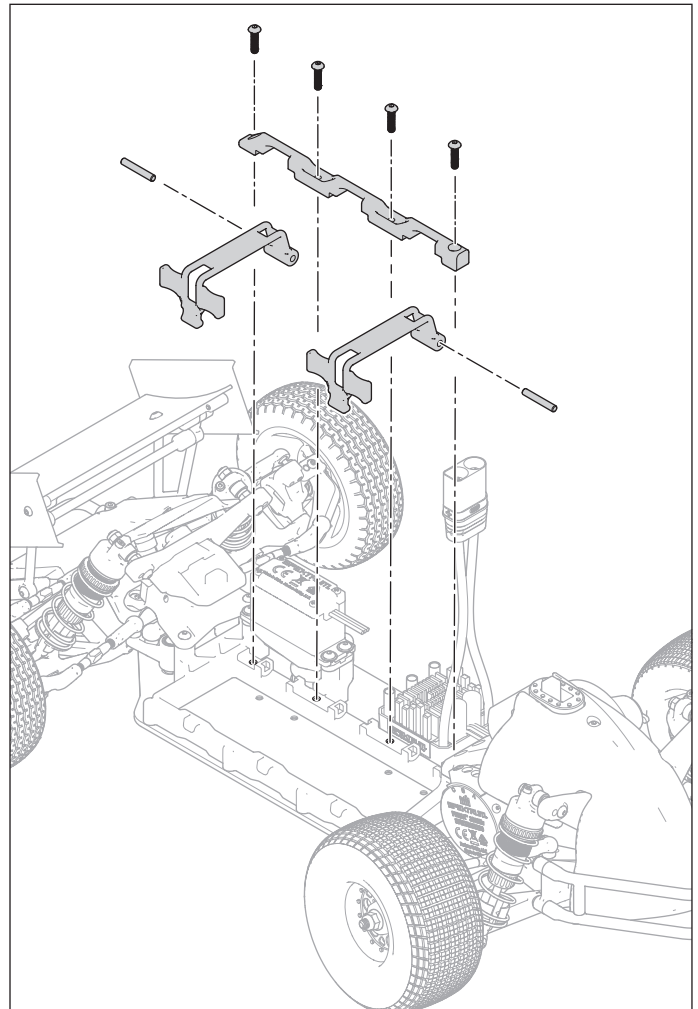

**BATTERY STOPS**

Optional battery stops are included to accommodate different size batteries.

To install battery stops:

1. Determine the positions of the battery stops for your batteries.
2. Use a 2mm hex driver and the included countersunk screws to install the battery stops as desired.

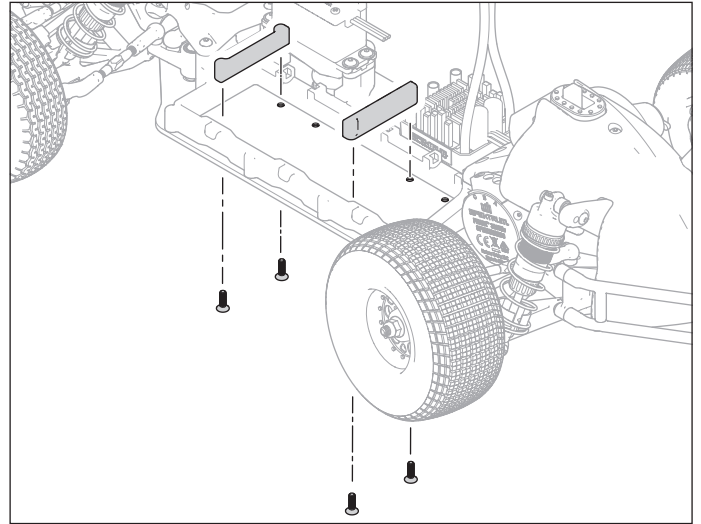

Center battery position

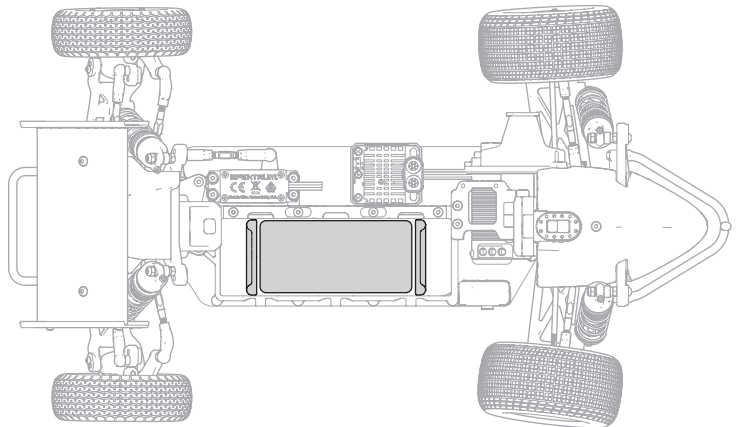

Forward battery position

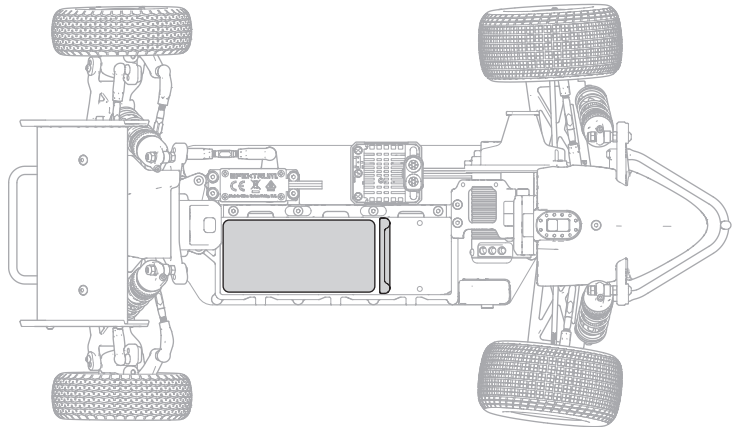

Rear battery position

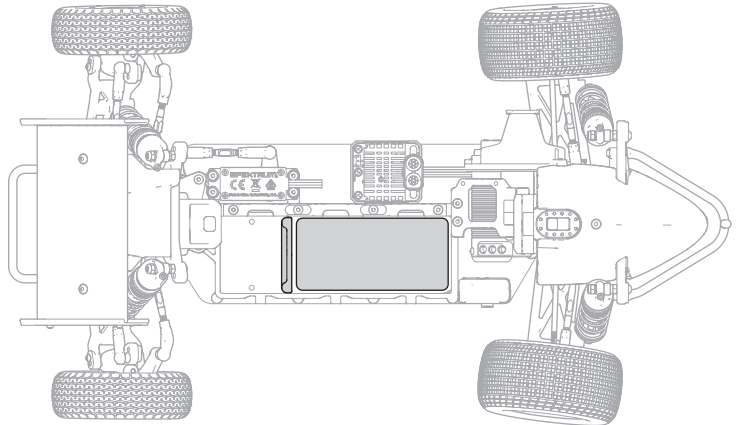

## AFTER YOUR RUN

When you are finished with your run:

1. Power the vehicle off by pressing and holding the power button until the orange LED turns off.
2. Power the transmitter off by pressing and holding the power button until the power LED turns off.

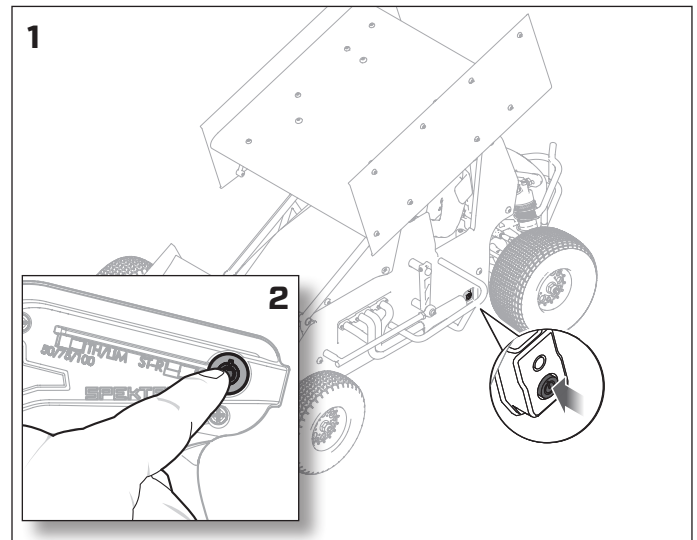

3. Remove the body and cage.
4. Disconnect the vehicle battery lead from the battery connector.

**NOTICE:** Never leave the battery lead connected to the vehicle when not in use. The battery will drain if left plugged in resulting in permanent battery damage. Damage to the battery or vehicle may result.

5. Remove the vehicle battery.
6. Recharge the vehicle battery or charge to storage level if you are done running the vehicle for the day.

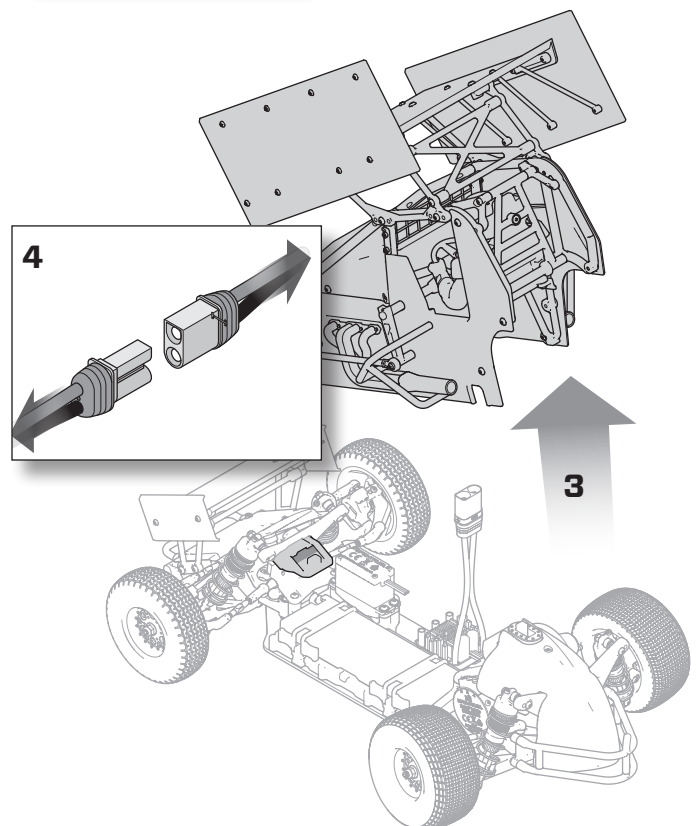

## CHANGING TO WINGLESS

### WINGLESS

The vehicle includes option parts to remove the wings and install a front name plate and top support bracket.

To remove the main wing:

1. Use a 2mm hex driver to remove the top wing assembly
2. Use a 2mm hex driver to remove the top wing support.

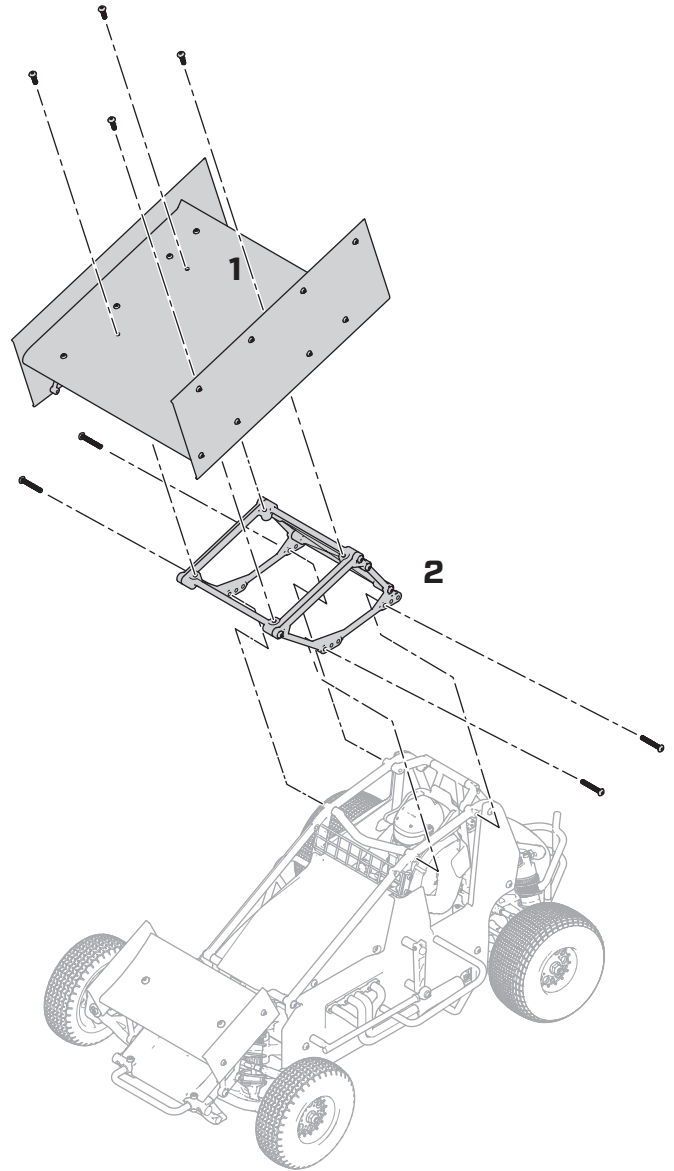

3. Install the front name plate bracket using the supplied screws in the manual bag..
4. Install (2) shorter M3x14mm screws supplied in the manual bag onto the rear seat back support.
5. Use a 2mm hex driver to install the Front Name Plate
6. Install the optional sticker to cover up the screw holes for a cleaner look.

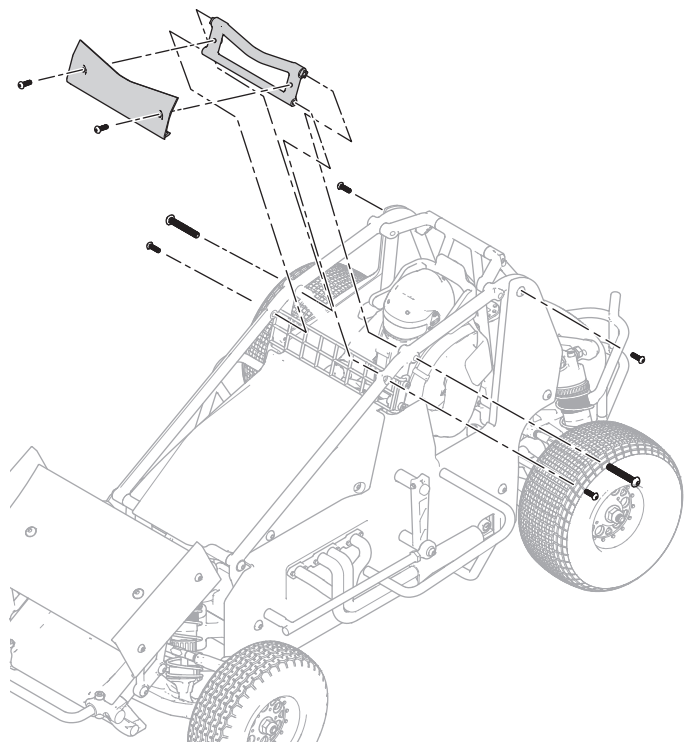

To remove the front wing:

1. Use a 1.5mm hex driver to remove the mud cover from the front right wheel.
2. Use a 7mm socket to remove the front wheels.
3. Use a 2mm hex driver to remove the front wing assembly.
4. Reinstall the wheels and mud cover.

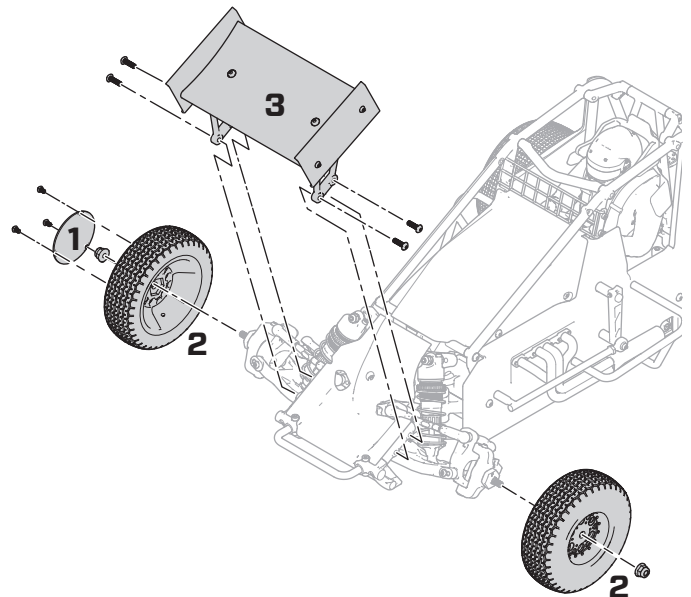

## MAINTENANCE

### SERVO SAVER

The vehicle includes a solid arm and a stiffer option replacement spring.

To add the servo saver spring:

1. Use a 2mm hex driver to remove the steering servo.
2. Use a 2mm hex driver to remove the servo saver from the servo.
3. Add the spring in the assembly by pushing the spring over the existing spring assembly. This will increase the resistance and add additional steering response.

OR

To install the solid servo horn, remove the Servo Saver spline by sliding it off the servo spline.

4. Power the servo and ensure it is centered when you install the arm.
5. Install the arm in a neutral position, with the transmitter trim centered.

**IMPORTANT:** A shorter M3 screw is required to use the solid servo horn. Please use an M3x8mm

6. Reinstall the servo.

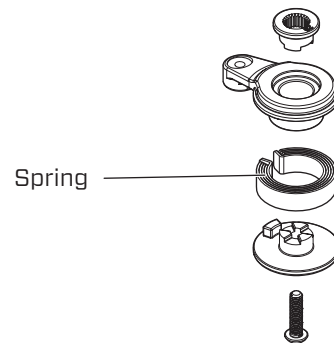

### TO CLEAN THE BODY LATCH:

1. Use a 2mm hex driver to remove the two button head screws holding the rear cover.
2. Use a 7mm socket to to remove the left rear wheel.

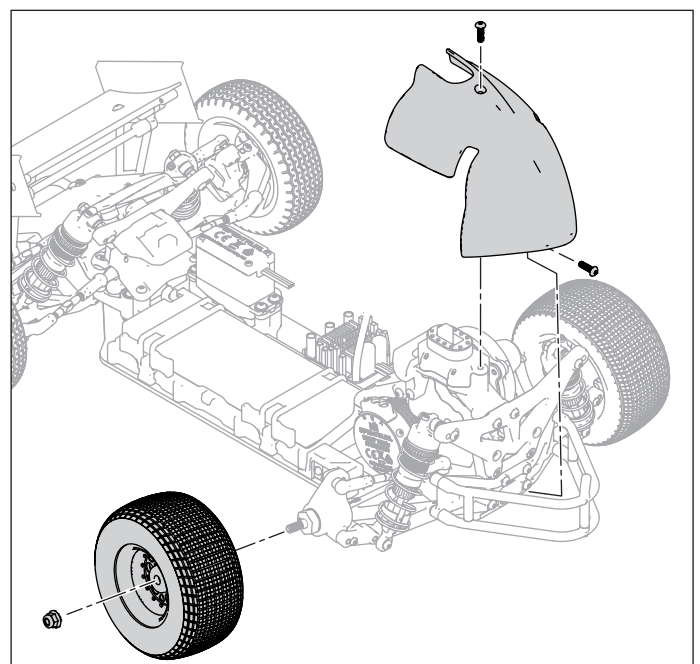

3. Use a 2mm hex driver to remove the latch assembly.
4. Disassemble the latch assembly.
5. Clean all the parts with a soft plastic brush.
6. Reassemble the latch and reinstall it on the vehicle.

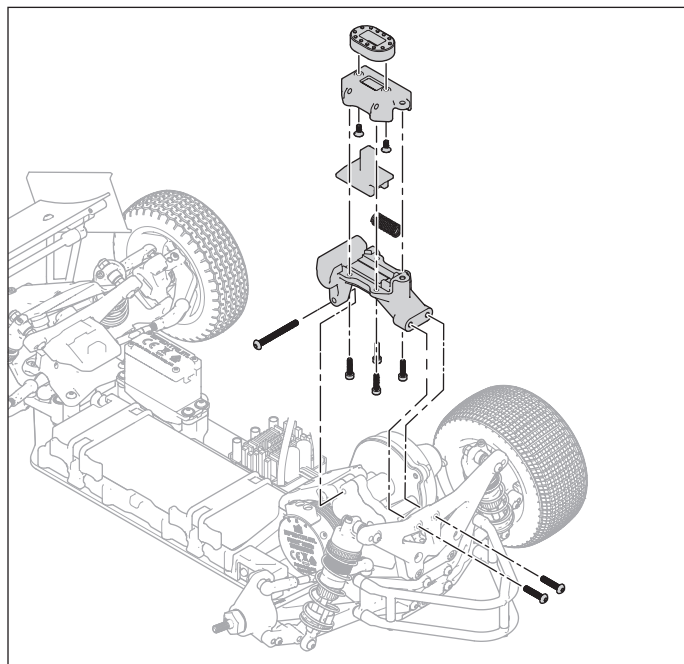

**CAMBER ADJUSTMENT**

Camber is the angle of the wheel top leaning in or out from the center of the chassis.

When the top of the tire leans toward the center line of the car, the tire has negative camber. When the top of the tire leans away from the centerline of the car, the tire has positive camber.

**Front Camber**

The stock 22S Sprint is setup from the factory to be used on a dirt oval track and constant left turn. The front camber is set to these settings: Left Front: +2, Right Front -2

**Rear Camber**

The stock 22S Sprint car is setup to have maximum traction while maintaining stability around a dirt oval track. The factory settings for the rear camber settings: Left Rear +2, Right Rear -3

**TOE ADJUSTMENT**

Toe is the alignment of the wheel fronts to the center line of the chassis.

Toe-in is the wheel fronts going towards the center

Toe-out is the wheel fronts going away from the center

**FRONT**

The front toe is set from the factory with 1 deg. of toe-out. Adding toe out will make the steering feel smoother from center, but have a little less steering mid-corner. Adding toe in will make the steering feel more aggressive off center, and have more steering mid-corner.

**REAR**

The 22S Sprint is setup with fixed rear toe designed to work best on a dirt oval track. The right rear tire is set to have 3° of toe-in

The left rear tire is set to have 7° of toe-in

Note: The rear of the 22S sprint is designed to have a little rear steer providing the best forward traction while turning left around a dirt oval track.

**NEGATIVE CAMBER**

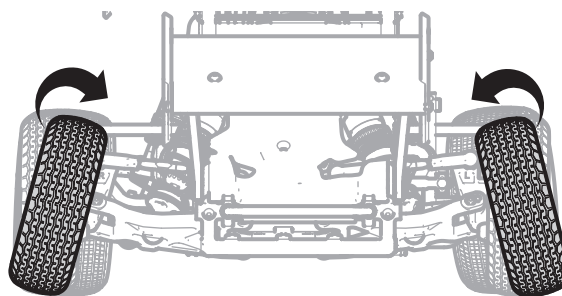

**TOE-IN**

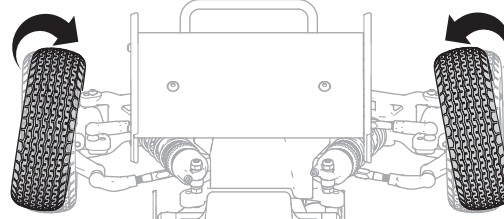

**TOE-OUT**

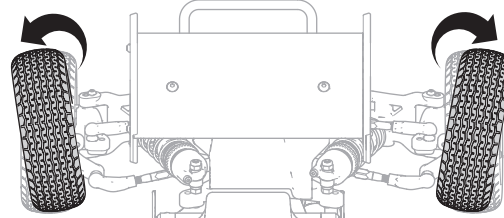

## SHOCK DISASSEMBLY/CLEANING

Remove the shocks and service as needed. Replace worn parts.

1. Remove spring cup. Pull the spring up and away from the lower cup. Slide the lower spring cup up and off of the shaft. Clean with a soft brush.
2. Use the shock tools to hold the shock body and remove the top cap.  
Empty the fluid from out of the shock.
3. Hold the shaft with a multi-wrench and remove the shock end. Push the shaft into the shock body and remove through the top. Remove the lower shock cap, O-rings and spacer. Clean the shock body. Install new O-rings, re-install the spacer, replace the O-ring and install the lower shock cap. **DO NOT TIGHTEN**. Install the shock shaft through the shock bottom and tighten the bottom cap. Re-install the shock end on the shaft.

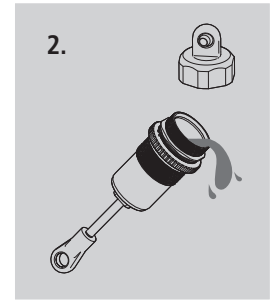
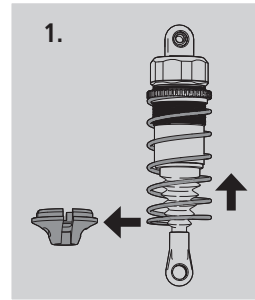

## REFILLING/BLEEDING SHOCKS

1. Fill the shock body 5mm (0.2 in) from the top with (30wt front shock TLR74006 2oz) (35wt rear shock TLR74008 2oz) silicone shock oil.
2. Slowly move the piston up and down 5 times, allowing air to rise to the top. Let the shock sit for 30 seconds.
3. With the piston all the way down, fill the shock body flush to the top.
4. To use the bleeder cap, remove the bleeder screw from the cap and fill the shock body full of fluid with the piston at the lowest setting.
5. Tighten the cap to the shock body and push the shock shaft in slowly letting excess fluid from the shock out.
6. When the shock is fully compressed reinstall the bleeder screw.
7. Replace the spring and spring cup.

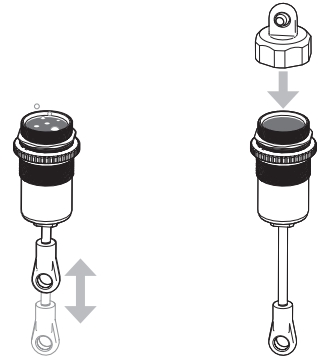
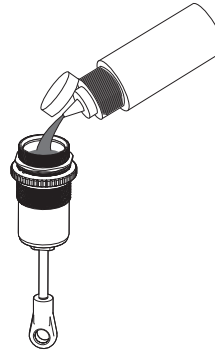

## DIFFERENTIAL

Light Weight Oil	Heavier Weight Oil
Has more side traction and increased steering in the middle of a turn	Has less steering in the middle of the turn but more forward traction

1. To remove the differential from the transmission, begin by removing the rear wheels.
2. Remove the tail tank using a 2mm hex driver and removing the top and bottom screw.
3. Remove the Cage Mounting Latch by removing the (2) screws on the shock tower and the single pivot screw going through the transmission case using a 2mm hex driver.
4. Remove the fan mount by removing the two screws attached to the battery tray and the single pivot screw going through the transmission case using a 2mm hex driver.
5. Remove the 4 flat head screws on the underside of the chassis holding the transmission case to the aluminum chassis using a 2mm hex driver.
6. Remove the last two remaining screws on top of the transmission that is attached to the camber block using a 2mm hex driver.
7. Remove the transmission from the chassis and remove the remaining screws holding the two halves of the transmission together using a 2mm hex driver.  
**IMPORTANT:** When replacing the transmission after Diff maintenance make sure the drive shafts are inserted into the outdrives before securing the transmission to the chassis.
8. If fluid is leaking, replace the outdrive o-rings and gasket. Be sure to grease the outdrives prior to sliding them through the o-rings. (LOSA99209).
9. Check the differential fluid and refill or replace as needed with TLR5279 (3,000CS) fluid. The fluid level should be about 0.12 in (3.0mm) from the top surface of the case. Do not overfill or the differential unit might leak.

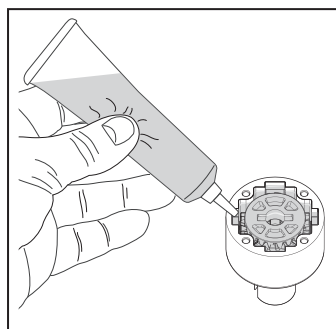

Differential Fluid : 3,000 (TLR5279)

## RIDE HEIGHT

Ride height provides more or less traction based on the roll of the chassis. The higher the ride height the more roll the chassis will have thus reducing traction. Lowering the ride height will reduce roll and provide additional traction. The goal is to set the ride height as low as possible without the chassis hitting the ground based on the conditions of the track.

To raise or lower the ride height adjust the shock collars up or down by spinning clockwise to raise the ride height, or counter-clockwise to lower the ride height.

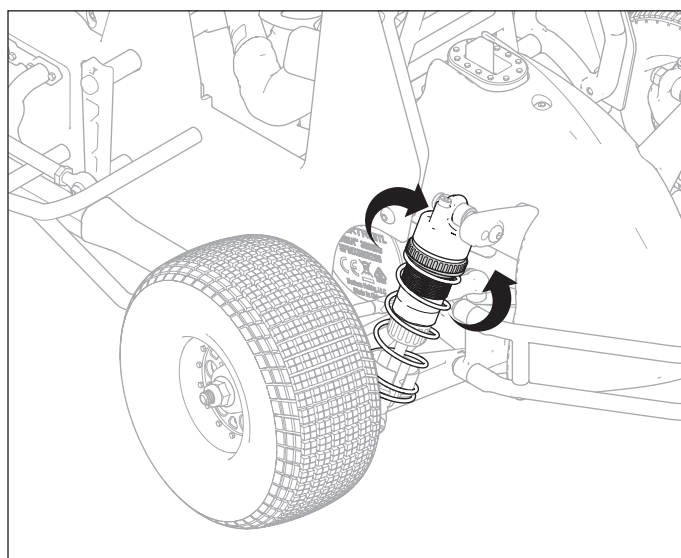

## ESC PROGRAMMING

### SPECIFICATIONS

<b>Type</b>	Sensorless, SMART Throttle Compatible
<b>Output</b>	45A
<b>Function</b>	Forward/Brake-Forward/Brake Reverse
<b>Input Voltage</b>	2S LiPo
<b>BEC Output</b>	6V and 7.4V Selectable @ 4A
<b>Dimensions (LxWxH)</b>	1.7 in (43.4mm) x 1.5 in (38.3mm) x 1.3 in (33.4mm)
<b>Weight</b>	5.4 oz (153g)

### ESC LED STATUS

- The ESC LEDs will flash when there is no throttle input from the transmitter.
- When full throttle is applied the ESC will have a glowing red and green LED.
- The red ESC LED glows when there is any throttle input from the transmitter.

### ESC CALIBRATION PROCEDURE

Complete the transmitter/receiver binding procedure prior to calibrating the ESC.

1. Set the transmitter throttle channel to 100% travel and center the throttle trim.
2. Connect a battery to the ESC battery lead.
3. Power on the transmitter.
4. Press and hold the SET button while turning on the ESC. Release the SET button when the red LED begins to flash, indicating the ESC is in calibration mode. The ESC will enter programming mode if the button is held for more than three seconds.
5. TIP: The red LED should be flashing when the ESC enters calibration mode. If the green LED is flashing the ESC has entered programming mode. Power off the ESC and repeat step 4, releasing the SET button when the red LED begins to flash.
6. With the transmitter throttle trigger at the neutral position, press and release the ESC SET button. The red LED will stop flashing, the green LED will flash one time and the motor will make a tone to indicate the neutral position has been accepted.
7. While holding the throttle trigger at the full throttle position, press and release the ESC SET button. The green LED will flash twice and the motor will make two tones to indicate the full throttle position has been accepted.
8. While holding the throttle trigger at the full brake position, press and release the SET button. The green LED will flash three times and the motor will make three tones to indicate the full brake position has been accepted.

The motor will operate normally after calibration is completed.

### ESC FUNCTIONS AND MODES

The ESC includes programming options so you can adjust the way your vehicle performs. Refer to the programming table to adjust the ESC for your driving conditions.

### PROGRAMMING TABLE

■ Default Settings

Programmable Items	Parameter Options								
	1	2	3	4	5	6	7	8	9
1. Running Mode	Forward / Brake	Forward/Reverse w / Brake							
2. Drag Brake Force	0%	2%	4%	6%	8%	10%	12%	14%	16%
3. Low-voltage Cutoff	3.2V	3.3V	3.4V	3.5V	3.6V	3.7V			
4. Start Mode/Punch	Level 1	Level 2	Level 3	Level 4	Level 5	Level 6	Level 7	Level 8	Level 9
5. Max Brake Force	25%	37.5%	50%	62.5%	75%	87.5%	100%	(disabled)	
6. Max Reverse Force	25%	50%	75%	100%					
7. Neutral Range	6% (Narrow)	9% (Normal)	12% (Wide)						
8. Motor Rotation	CCW	CW							
9. BEC Voltage	6.0V	7.4V							
10. Battery Mode	Li-Po	NiMH							

### AUDIBLE WARNING TONES

1. **Input Voltage:** The ESC checks the input voltage when it is powered ON. If a voltage problem is detected, the ESC continuously sounds 2 beeps with a 1 second pause (xx-xx-xx). Power OFF the ESC and ensure the connections are secure and that the battery power is not too low for safe operation.
2. **Radio Connection:** The ESC checks radio signal input when it is powered ON. If a problem is detected, the ESC continuously flashes the red LED 1 time per second. Power OFF the ESC and ensure the radio system is operating correctly.

**NOTICE:** Always disconnect the battery from the ESC after operating your vehicle. The ESC's switch only controls power to the receiver and servos. The ESC will continue to draw current when connected to the battery, resulting in possible damage to the battery through over discharge.

### ESC PROGRAMMING PROCEDURE

Programming is accomplished using the SET button on the ON/OFF switch\*.

1. Connect a fully charged battery to the ESC.
2. Power on the transmitter.
3. Power on the ESC.
4. Hold the SET button until the green LED flashes. Release the set button to enter programming mode.
5. TIP: To reset all programming items to the default values, press and hold the set button for five seconds.
6. Press and release the set button as needed to cycle through the programming items. The number of times the green LED flashes equals the programming item number given in the programming table.
7. When at the desired programming item, press and hold the set button until the red LED flashes to select the item.
8. Press and release the SET button to cycle through the values available for the programming item based on the number of times the LED flashes. Refer to the programming table.
9. Save the setting by pressing and holding the SET button for 3 seconds.
10. Power off the ESC to exit programming mode or to change other programming items.

\* Other programming options include the Spektrum SMART Firma ESC Programming Box (SPMXCA200) and the SmartLink USB updating and programmer application. See SpektrumRC.com for more details about Spektrum SMART Firma ESCs.



## TROUBLESHOOTING GUIDE

PROBLEM	POSSIBLE CAUSE	SOLUTION
Vehicle does not operate	Battery not charged or plugged in	Charge battery/plug in
	ESC switch not "On"	Turn on ESC switch
	Transmitter not "On" or low battery	Turn on/replace batteries
Motor runs but wheels do not rotate	Pinion not meshing with spur gear	Adjust pinion/spur mesh
	Pinion spinning on motor shaft	Tighten pinion gear setscrew on motor shaft flat spot
	Transmission gears stripped	Replace transmission gears
	Drive pin broken	Check and replace drive pin
Steering does not work	Servo plug not in receiver properly	Make sure the steering servo plug is connected to the receiver steering channel, noting proper polarity
	Servo gears or motor damaged	Replace or repair servo
Will not turn one direction	Servo gears damaged	Replace or repair servo
Motor does not run	Motor wire solder joint is damaged	Resolder the motor wire with the proper equipment
	Motor wire broken	Repair or replace as needed
	ESC damaged	Contact Horizon Hobby Product Support
ESC gets hot	Motor over-gearred	Use smaller pinion or larger spur gear
	Driveline bound up	Check wheels and transmission for binding
Poor run time and/or sluggish acceleration	Battery pack not fully charged	Recharge battery
	Charger not allowing full charge	Try another charger
	Driveline bound up	Check wheels, transmission for binding
Poor range and/or glitching	Transmitter batteries low	Check and replace
	Damage to Antenna wire	Replace receiver
	Loose plugs or wires	Check all wire connections and plugs

## LIMITED WARRANTY

### What this Warranty Covers

Horizon Hobby, LLC, (Horizon) warrants to the original purchaser that the product purchased (the "Product") will be free from defects in materials and workmanship for a period of 2 years from the date of purchase.

### What is Not Covered

This warranty is not transferable and does not cover (i) cosmetic damage, (ii) damage due to acts of God, accident, misuse, abuse, negligence, commercial use, or due to improper use, installation, operation or maintenance, (iii) modification of or to any part of the Product, (iv) attempted service by anyone other than a Horizon Hobby authorized service center, (v) Product not purchased from an authorized Horizon dealer, or (vi) Product not compliant with applicable technical regulations or (vii) use that violates any applicable laws, rules, or regulations.

OTHER THAN THE EXPRESS WARRANTY ABOVE, HORIZON MAKES NO OTHER WARRANTY OR REPRESENTATION, AND HEREBY DISCLAIMS ANY AND ALL IMPLIED WARRANTIES, INCLUDING, WITHOUT LIMITATION, THE IMPLIED WARRANTIES OF NON-INFRINGEMENT, MERCHANTABILITY AND FITNESS FOR A PARTICULAR PURPOSE. THE PURCHASER ACKNOWLEDGES THAT THEY ALONE HAVE DETERMINED THAT THE PRODUCT WILL SUITABLY MEET THE REQUIREMENTS OF THE PURCHASER'S INTENDED USE.

### Purchaser's Remedy

Horizon's sole obligation and purchaser's sole and exclusive remedy shall be that Horizon will, at its option, either (i) service, or (ii) replace, any Product determined by Horizon to be defective. Horizon reserves the right to inspect any

and all Product(s) involved in a warranty claim. Service or replacement decisions are at the sole discretion of Horizon. Proof of purchase is required for all warranty claims. SERVICE OR REPLACEMENT AS PROVIDED UNDER THIS WARRANTY IS THE PURCHASER'S SOLE AND EXCLUSIVE REMEDY.

### Limitation of Liability

HORIZON SHALL NOT BE LIABLE FOR SPECIAL, INDIRECT, INCIDENTAL OR CONSEQUENTIAL DAMAGES, LOSS OF PROFITS OR PRODUCTION OR COMMERCIAL LOSS IN ANY WAY, REGARDLESS OF WHETHER SUCH CLAIM IS BASED IN CONTRACT, WARRANTY, TORT, NEGLIGENCE, STRICT LIABILITY OR ANY OTHER THEORY OF LIABILITY, EVEN IF HORIZON HAS BEEN ADVISED OF THE POSSIBILITY OF SUCH DAMAGES. Further, in no event shall the liability of Horizon exceed the individual price of the Product on which liability is asserted. As Horizon has no control over use, setup, final assembly, modification or misuse, no liability shall be assumed nor accepted for any resulting damage or injury. By the act of use, setup or assembly, the user accepts all resulting liability. If you as the purchaser or user are not prepared to accept the liability associated with the use of the Product, purchaser is advised to return the Product immediately in new and unused condition to the place of purchase.

### Law

These terms are governed by Illinois law (without regard to conflict of law principals). This warranty gives you specific legal rights, and you may also have other rights which vary from state to state. Horizon reserves the right to change or modify this warranty at any time without notice.

## WARRANTY SERVICES

### Questions, Assistance, and Services

Your local hobby store and/or place of purchase cannot provide warranty support or service. Once assembly, setup or use of the Product has been started, you must contact your local distributor or Horizon directly. This will enable Horizon to better answer your questions and service you in the event that you may need any assistance. For questions or assistance, please visit our website at [www.horizonhobby.com](http://www.horizonhobby.com), submit a Product Support Inquiry, or call the toll free telephone number referenced in the Warranty and Service Contact Information section to speak with a Product Support representative.

### Inspection or Services

If this Product needs to be inspected or serviced and is compliant in the country you live and use the Product in, please use the Horizon Online Service Request submission process found on our website or call Horizon to obtain a Return Merchandise Authorization (RMA) number. Pack the Product securely using a shipping carton. Please note that original boxes may be included, but are not designed to withstand the rigors of shipping without additional protection. Ship via a carrier that provides tracking and insurance for lost or damaged parcels, as Horizon is not responsible for merchandise until it arrives and is accepted at our facility. An Online Service Request is available at [http://www.horizonhobby.com/content/service-center\\_render-service-center](http://www.horizonhobby.com/content/service-center_render-service-center). If you do not have internet access, please contact Horizon Product Support to obtain a RMA number along with instructions for submitting your product for service. When calling Horizon, you will be asked to provide your complete name, street address, email address and phone number where you can be reached during business hours. When sending product into Horizon, please include your RMA number, a list of the included items, and a brief summary of the problem. A copy of your original sales receipt must be included for warranty consideration. Be sure your name, address, and RMA number are clearly written on

the outside of the shipping carton.

**NOTICE:** Do not ship Li-Po batteries to Horizon. If you have any issue with a Li-Po battery, please contact the appropriate Horizon Product Support office.

### Warranty Requirements

For Warranty consideration, you must include your original sales receipt verifying the proof-of-purchase date. Provided warranty conditions have been met, your Product will be serviced or replaced free of charge. Service or replacement decisions are at the sole discretion of Horizon.

### Non-Warranty Service

Should your service not be covered by warranty, service will be completed and payment will be required without notification or estimate of the expense unless the expense exceeds 50% of the retail purchase cost. By submitting the item for service you are agreeing to payment of the service without notification. Service estimates are available upon request. You must include this request with your item submitted for service. Non-warranty service estimates will be billed a minimum of 1/2 hour of labor. In addition you will be billed for return freight. Horizon accepts money orders and cashier's checks, as well as Visa, MasterCard, American Express, and Discover cards. By submitting any item to Horizon for service, you are agreeing to Horizon's Terms and Conditions found on our website [http://www.horizonhobby.com/content/service-center\\_render-service-center](http://www.horizonhobby.com/content/service-center_render-service-center).

**ATTENTION:** Horizon service is limited to Product compliant in the country of use and ownership. If received, a non-compliant Product will not be serviced. Further, the sender will be responsible for arranging return shipment of the un-serviced Product, through a carrier of the sender's choice and at the sender's expense. Horizon will hold non-compliant Product for a period of 60 days from notification, after which it will be discarded.

10/15

## WARRANTY AND SERVICE CONTACT INFORMATION

COUNTRY OF PURCHASE	HORIZON HOBBY	CONTACT INFORMATION	ADDRESS
United States of America	Horizon Service Center (Repairs and Repair Requests)	<a href="http://servicecenter.horizonhobby.com/RequestForm/">servicecenter.horizonhobby.com/RequestForm/</a>	2904 Research Rd. Champaign, Illinois 61822 USA
	Horizon Product Support (Product Technical Assistance)	<a href="mailto:productsupport@horizonhobby.com">productsupport@horizonhobby.com</a> 877-504-0233	
	Sales	<a href="mailto:websales@horizonhobby.com">websales@horizonhobby.com</a> 800-338-4639	
European Union	Horizon Technischer Service	<a href="mailto:service@horizonhobby.de">service@horizonhobby.de</a> +49 (0) 4121 2655 100	Hanskampring 9 D 22885 Barsbüttel, Germany
	Sales: Horizon Hobby GmbH		



## FCC INFORMATION

**FCC ID: BRWSPMSLT200F**

**FCC ID: BRWSRIRVINGV1**

This equipment complies with FCC and IC radiation exposure limits set forth for an uncontrolled environment. This equipment should be installed and operated with minimum distance 20cm between the radiator and/or antenna and your body (excluding fingers, hands, wrists, ankles and feet). This transmitter must not be co-located or operating in conjunction with any other antenna or transmitter.

### SUPPLIER'S DECLARATION OF CONFORMITY

**LOSI Sprint 22S RTR (LOS-1387, LOS-2359)**

**FC** This device complies with part 15 of the FCC Rules. Operation is subject to the following two conditions:  
(1) This device may not cause harmful interference, and (2) this device must accept any interference received, including interference that may cause undesired operation.

**CAUTION:** Changes or modifications not expressly approved by the party responsible for compliance could void the user's authority to operate the equipment.

**NOTE:** This equipment has been tested and found to comply with the limits for a Class B digital device, pursuant to part 15 of the FCC Rules. These limits are

designed to provide reasonable protection against harmful interference in a residential installation. This equipment generates, uses and can radiate radio frequency energy and, if not installed and used in accordance with the instructions, may cause harmful interference to radio communications. However, there is no guarantee that interference will not occur in a particular installation. If this equipment does cause harmful interference to radio or television reception, which can be determined by turning the equipment off and on, the user is encouraged to try to correct the interference by one or more of the following measures:

- Reorient or relocate the receiving antenna.
- Increase the separation between the equipment and receiver.
- Connect the equipment into an outlet on a circuit different from that to which the receiver is connected.
- Consult the dealer or an experienced radio/TV technician for help.

Horizon Hobby, LLC  
2904 Research Road Champaign, IL 61822  
Email: [compliance@horizonhobby.com](mailto:compliance@horizonhobby.com)  
Web: [HorizonHobby.com](http://HorizonHobby.com)

## IC INFORMATION

**CAN ICES-3 (B)/NMB-3(B)**

**IC: 6157A-SPMSLT200F**

**IC: 6157A-SRIRVINGV1**

This device contains license-exempt transmitter(s)/receivers(s) that comply with Innovation, Science, and Economic Development Canada's license-exempt RSS(s).

Operation is subject to the following 2 conditions:

1. This device may not cause interference.
2. This device must accept any interference, including interference that may cause undesired operation of the device.

## COMPLIANCE INFORMATION FOR THE EUROPEAN UNION

### EU COMPLIANCE STATEMENT:

**LOSI Sprint 22S RTR (LOS-1387);** Hereby, Horizon Hobby, LLC declares that the device is in compliance with the following: Radio Equipment Directive (RED) 2014/53/EU; RoHS 2 Directive 2011/65/EU; RoHS 3 Directive - Amending 2011/65/EU Annex II 2015/863.

**LOSI Sprint 22S RTR (LOS-2359);** Hereby, Horizon Hobby, LLC declares that the device is in compliance with the following: Radio Equipment Directive (RED) 2014/53/EU; Low Voltage Directive (LVD) 2014/35/EU; 2014/30/EU EMC Directive; RoHS 2 Directive 2011/65/EU; RoHS 3 Directive - Amending 2011/65/EU Annex II 2015/863.

The full text of the EU declaration of conformity is available at the following internet address: <https://www.horizonhobby.com/content/support-render-compliance>.

**NOTE:** This product contains batteries that are covered under the 2006/66/EC European Directive, which cannot be disposed of with normal household waste. Please follow local regulations.

### Wireless Frequency Range and Wireless Output Power:

#### Transmitter:

2410 - 2480 MHz  
13.66dBm

#### Receiver:

2404 - 2476 MHz  
-1.33dBm

### EU Manufacturer of Record:

Horizon Hobby, LLC  
2904 Research Road  
Champaign, IL 61822 USA

### EU Importer of Record:

Horizon Hobby, GmbH  
Hanskampring 9  
22885 Barsbüttel Germany

### WEEE NOTICE:



This appliance is labeled in accordance with European Directive 2012/19/EU concerning waste of electrical and electronic equipment (WEEE). This label indicates that this product should not be disposed of with household waste. It should be deposited at an appropriate facility to enable recovery and recycling.



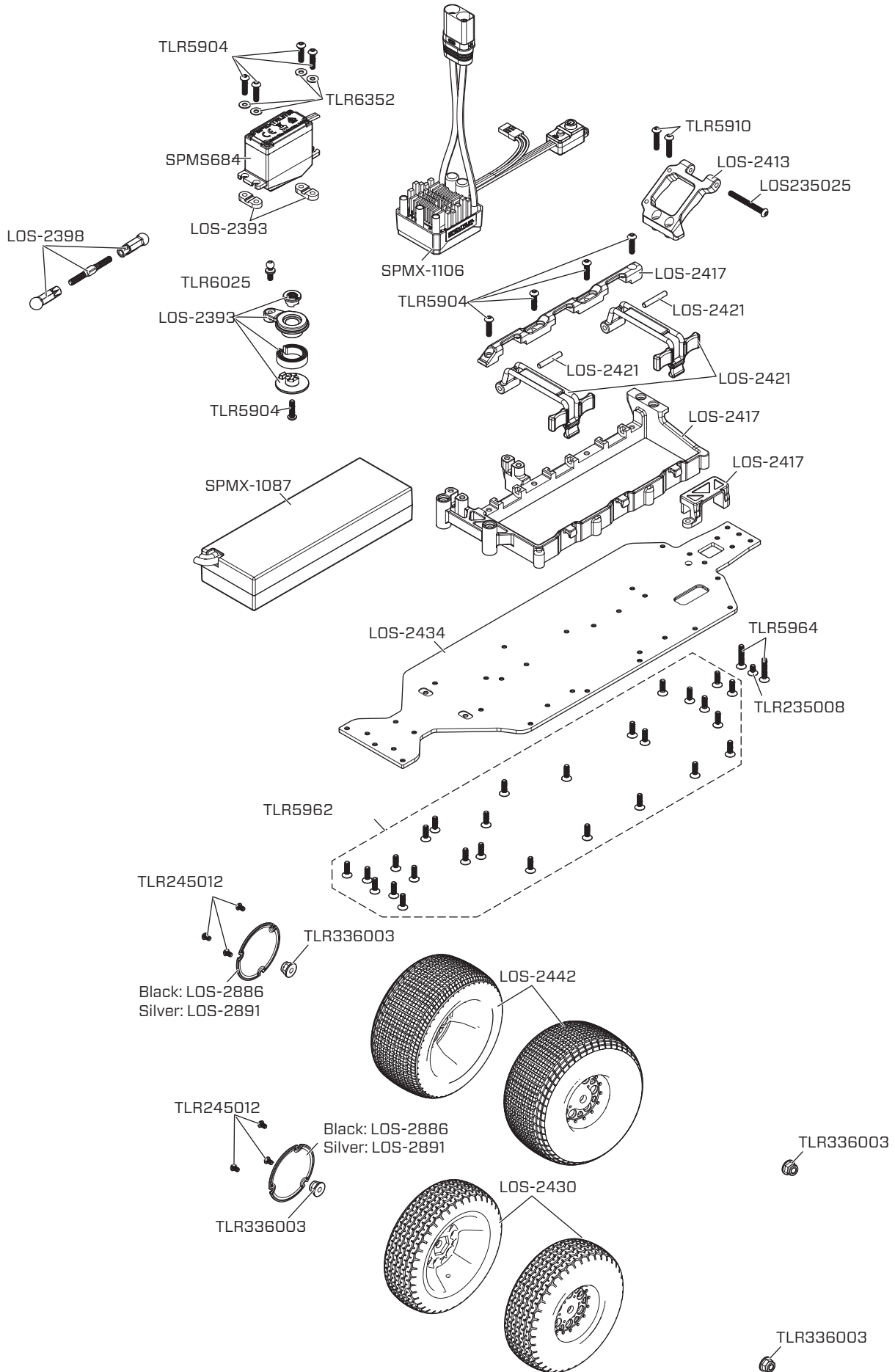

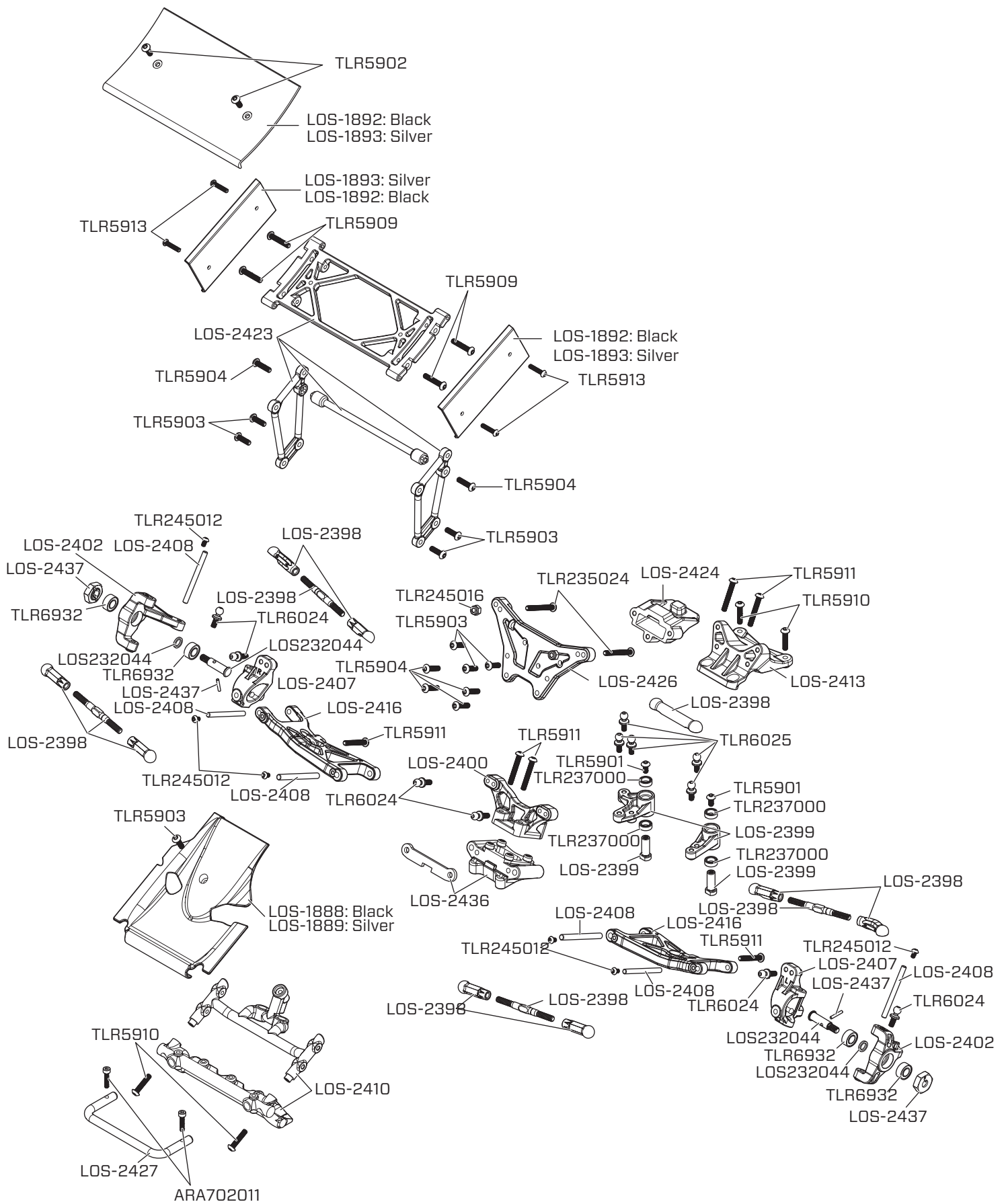

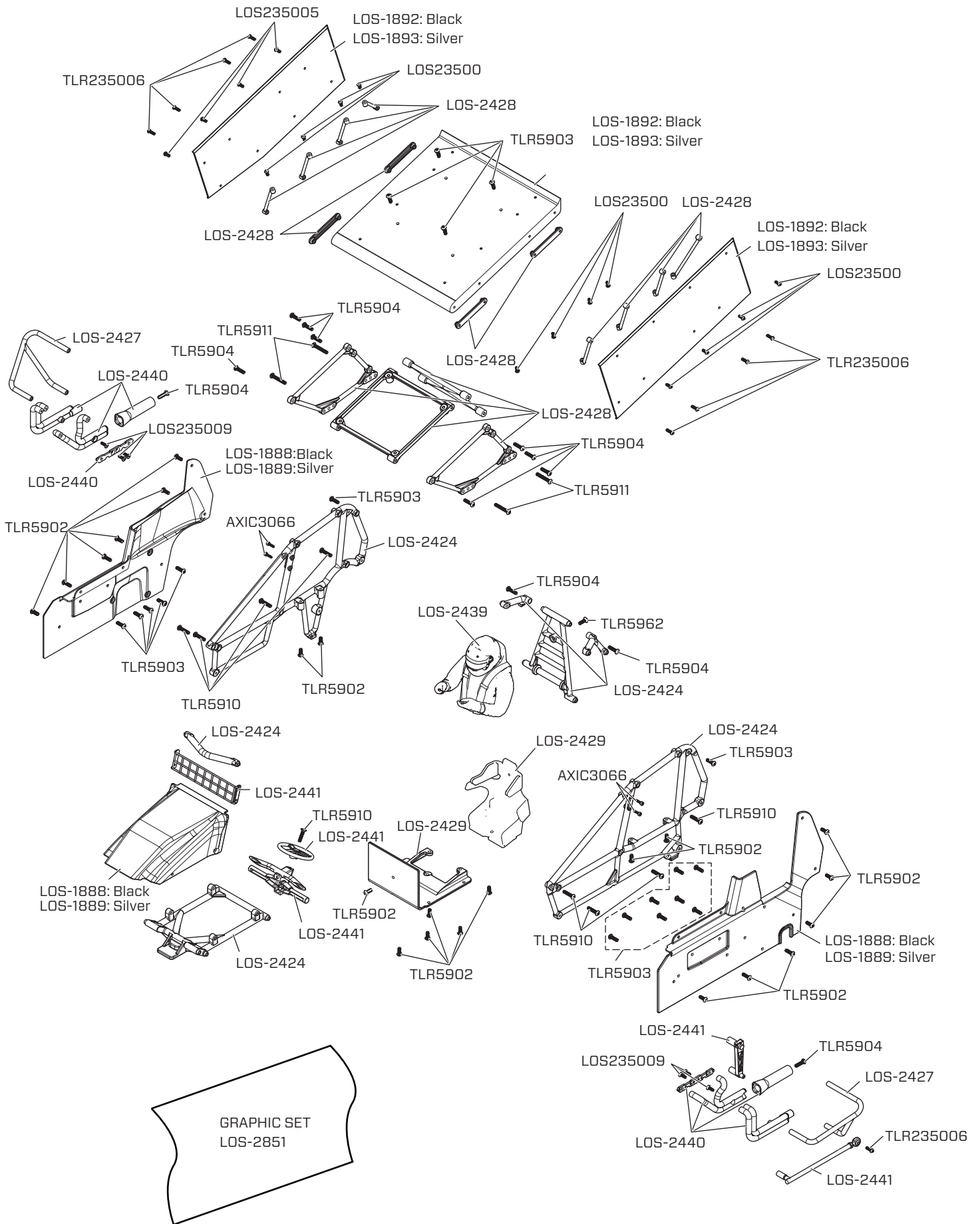



Front LOS-2412  
30wt

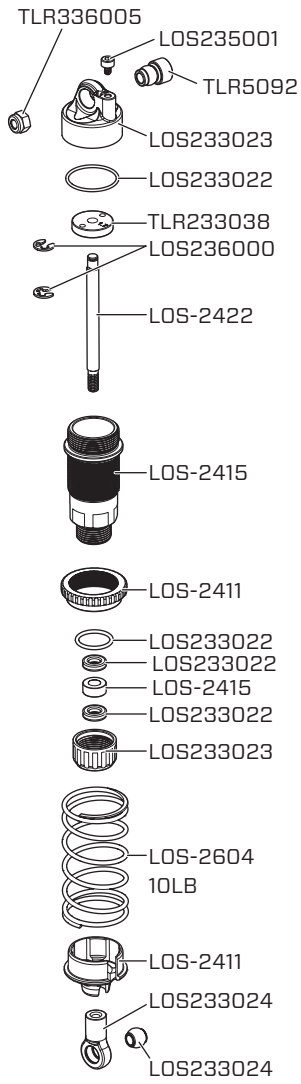

Rear: LOS-2419  
35wt

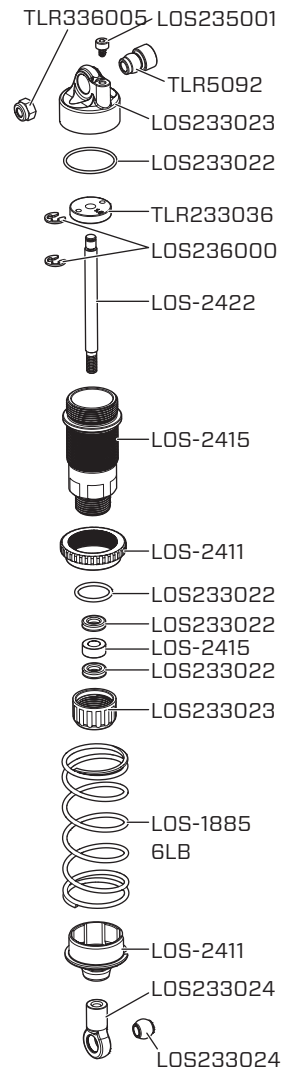

**REPLACEMENT PARTS | ERSATZTEILE | PIÈCES DE RECHANGE | PARTI DI RICAMBIO**

#	DESCRIPTION	BESCHREIBUNG	DESCRIPTION	DESCRIZIONE
ARA702011	CAP HEAD SCREW M2.5X12MM (10PCS)	INBUSSCHRAUBE, M2,5 X 12 MM (10 STCK.)	VIS D'ASSEMBLAGE CREUSE M2,5 X 12 MM (10)	VITI TESTA CILINDRICA M2.5X12 MM (10)
ARAC9809	AR710001 E-CLIPS E-2 (10)	AR710001 E-KLAMMERN E-2 (10)	ATTACHES EN E E-2 AR710001 (10)	AR710001 E-CLIP E-2 (10)
AXIC0146	HEX SOCKET FLAT HEAD M3X12MM BLACK (10)	M3 X 12 MM SECHSKANT-FLACHKOPF, SCHWARZ (10)	DOUILLE À SIX PANS À TÊTE PLATE M3 X 12 MM, NOIRE (10)	VITI TESTA PIANA ES. INC. M3X12 MM NERO (10)
AXIC3066	CAP HEAD M2X8MM BLACK (10)	INBUSSCHRAUBE M2 X 8 MM SCHWARZ (10)	VIS D'ASSEMBLAGE CREUSE M2 X 8 MM, NOIRE (10)	VITI TESTA CILINDRICA M2X8 MM NERO (10)
AXI236136	C-CLIP, 5MM (10)	C-CLIPS, 5 MM (10)	ATTACHES EN C, 5 MM (10)	C-CLIP, 5 MM (10)
LOSA6955	5X13X4MM HD CLUTCH BEARINGS (2):8B/8T	5 X 13 X 4 MM HD KUPPLUNGSLAGER (2): 8B/8T	ROULEMENTS À EMBRAYAGE ULTRA-RÉSISTANTS 5 X 13 X 4 MM (2) : 8B/8T	CUSCINETTI FRIZIONE HD 5X13X4 MM (2):8B/8T
LOS235024	BUTTON HEAD SCREWS M3X25MM (10)	RUNDKOPFSCHRAUBEN, M3 X 25 MM (10)	VIS À TÊTE BOMBÉE M3 X 25 MM (10)	VITI TESTA TONDA, M3X25 MM (10)
LOS235009	FLAT HEAD SCREWS M2.5 X 8MM (10)	FLACHKOPFSCHRAUBEN M2,5 X 8 MM (10)	VIS À TÊTE PLATE M2,5 X 8 MM (10)	VITI TESTA PIANA, M2.5X8 MM (10)
LOS235031	CAP HEAD SCREWS, M2 X 12MM (10)	INBUSSCHRAUBEN M2 X 12 MM (10)	VIS D'ASSEMBLAGE, M2 X 12 MM (10)	VITI TESTA CILINDRICA, M2X12 MM (10)
LOS235005	BUTTON HEAD SCREWS M2.5X6MM (10)	RUNDKOPFSCHRAUBEN, M2,5 X 6 MM (10)	VIS À TÊTE BOMBÉE M2,5 X 6 MM (10)	VITI TESTA TONDA M2.5X6 MM (10)
LOS233024	SHOCK ENDS: 22S	STOSSDÄMPFERENDEN: 22S	EXTRÉMITÉS D'AMORTISSEURS : 22S	TERMINALI AMMORTIZZATORI: 22S
LOS232044	FRONT AXLE: 22S	VORDERACHSE: 22S	AXE AVANT : 22S	ASSALE ANTERIORE: 22S
LOS232042	IDLER GEAR & SHAFT: 22S	ZWISCHENRAD UND WELLE: 22S	PIGNON INTERMÉDIAIRE ET ARBRE : 22S	ALBERO E INGRANAGGIO FOLLE: 22S
LOS231050	STEERING BEARING SET: 22S	LENKLAGERSATZ: 22S	ENSEMBLE DE ROULEMENT DE DIRECTION : 22S	SET CUSCINETTI STERZO: 22S
LOS232039	COMPLETE GEAR DIFF: 22S	KOMPLETTES GETRIEBE DIFFERENTIAL: 22S	ENGRENAGE DIFFÉRENTIEL COMPLET : 22S	DIFFERENZIALE PIGNONE COMPLETO: 22S
LOS232043	LAYSHAFT & GEAR: 22S	ZWISCHENWELLE UND GETRIEBE: 22S	ARBRE INTERMÉDIAIRE ET ENGRENAGE : 22S	ALBERO SECONDARIO E INGRANAGGIO: 22S
LOS233022	SHOCK SEAL SET: 22S	STOSSDÄMPFERDICHTUNGSSATZ: 22S	ENSEMBLE DE JOINTS D'AMORTISSEURS : 22S	SET GUARNIZIONI AMMORTIZZATORI: 22S
LOS232038	SPUR GEAR & SLIPPER PADS, 48P, 84T: 22S	STIRNRAD UND GLEITKISSEN, 48P, 84TT: 22S	ENGRENAGE CYLINDRIQUE ET SABOTS DE PISTON, 48P, 84T : 22S	CORONA E PATTINI ANTISALTELLAMENTO 48P 84T: 22S
LOS232047	SLIPPER HARDWARE SET: 22S	GLEITER-HARDWARESATZ: 22S	ENSEMBLE DE MATÉRIEL DU SABOT : 22S	SET BULLONERIA PATTINO: 22S
LOS233023	SHOCK CAPS (2): 22S	STOSSDÄMPFERKAPPEN (2): 22S	CAPUCHONS D'AMORTISSEURS (2) : 22S	TAPPI AMMORTIZZATORE (2): 22S
LOS235025	BUTTON HEAD SCREWS M3X30MM (10)	RUNDKOPFSCHRAUBEN, M3 X 30 MM (10)	VIS À TÊTE BOMBÉE M3 X 30 MM (10)	VITI TESTA TONDA, M3X30 MM (10)
LOS232040	GEAR SET, GEAR DIFF: 22S	GETRIEBESATZ, GETRIEBE DIFFERENTIAL: 22S	ENSEMBLE D'ENGRENAGES, ENGRENAGE DIFFÉRENTIEL : 22S	SET INGRANAGGI, DIFFERENZIALE: 22S
LOS235018	SET SCREW, M3 X 3MM (10)	STELLSCHRAUBE, M3 X 3 MM (10)	VIS DE FIXATION, M3X3 MM (10)	VITI DI FERMO, M3X3 MM (10)



#	DESCRIPTION	BESCHREIBUNG	DESCRIPTION	DESCRIZIONE
LOSA6957	10X15X4 MM BB (2) WITH NYLON RETAINER	10 X 15 X 4 MM BB (2) MIT NYLON-HALTERUNG	ROULEMENTS À BILLES 10 X 15 X 4 MM (2) AVEC BAGUE DE RETENUE EN NYLON	CUSCINETTO A SFERA 10X15X4 MM CON FERMO IN NYLON (2)
LOSA6937	5X10X4MM SHIELDED BALL BEARING(2)	5 X 10 X 4 MM ABGEDICHTETES KUGELLAGER (2)	ROULEMENT À BILLES BLINDÉ, 5×10×4 MM (2)	CUSCINETTI A SFERA SCHERMATI 5X10X4 MM (2)
SPMSR215	SR215 DSMR 2 CH RECEIVER	SR215 DSMR 2-KANAL-EMPFÄNGER	RÉCEPTEUR SR215 DSMR 2 CANAUX	RICEVITORE SR215 DSMR 2 CH
SPMXC1020	SMART S120 USB-C CHARGER, 1X20W	SMART S120 USB-C-LADEGERÄT, 1X 20 W	CHARGEUR SMART S120 USB-C, 1X20 W	CARICABATTERIE SMART S120 USB-C, 1X20 W
TLR332022	PINION GEAR 22T, 48P, AL	ZAHNRADGETRIEBE 22T, 48P, AL	ENGRENAGE À PIGNONS 22T, 48P, EN ALUMINIUM	PIGNONE 22T, 48P, AL
TLR5902	BUTTON HEAD SCREWS, M3 X 8MM (10)	RUNDKOPFSCHRAUBEN, M3 X 8 MM (10)	VIS À TÊTE BOMBÉE, M3 X 8 MM (10)	VITI TESTA TONDA, M3X8 MM (10)
TLR245016	M3 FLANGED LOCK NUTS (10)	M3 SICHERUNGSMUTTERN MIT FLANSCH (10)	CONTRE-ÉCROUS À COLLET M3 (10)	DADI FLANGIATI M3 (10)
TLR232080	SLIPPER PADS, MAX DRIVE, SHDS (2)	GLEITKISSEN, MAX. ANTRIEB, SHDS (2)	SABOTS DE PISTONS, ENTRAÎNEMENT MAX., SABOT HAUTEMENT RÉSISTANT (2)	PATTINI ANTISALTELLAMENTO, MAX DRIVE, SHDS (2)
TLR5909	BUTTON HEAD SCREWS, M3 X 16MM (10)	RUNDKOPFSCHRAUBEN, M3 X 16 MM (10)	VIS À TÊTE BOMBÉE, M3 X 16 MM (10)	VITI TESTA TONDA, M3X16MM (10)
TLR6024	BALLSTUD, 4.8 X: 8MM (4): 22	KUGELKOPF, 4,8 X: 8 MM (4): 22	PITON À ROTULE, 4,8 X 8 MM (4) : 22	VITI A SFERA, 4,8 X: 8 MM (4): 22
TLR5962	FLATHEAD SCREWS, M3 X 10MM (10)	FLACHKOPFSCHRAUBEN, M3 X 10 MM (10)	VIS À TÊTE PLATE, M3×10 MM (10)	VITI TESTA PIANA, M3X10 MM (10)
TLR235003	FLAT HEAD SCREWS, M2.5 X 6MM (10)	FLACHKOPFSCHRAUBEN, M2,5 X 6 MM (10)	VIS À TÊTE PLATE, M2,5 X 6 MM (10)	VITI TESTA PIANA, M2.5X6 MM (10)
TLR235014	CAP HEAD SCREWS, M2.5 X 10MM (10)	INBUSSCHRAUBEN, M2,5 X 10 MM (10)	VIS D'ASSEMBLAGE CREUSES, M2.5 X 10 MM (10)	VITI TESTA CILINDRICA, M2.5X10 MM (10)
TLR235006	BUTTON HEAD SCREWS, M2.5 X 8MM (10)	RUNDKOPFSCHRAUBEN, M2,5 X 8 MM (10)	VIS À TÊTE BOMBÉE, M2.5 X 8 MM (10)	VITI TESTA TONDA, M2.5X8 MM (10)
TLR5904	BUTTON HEAD SCREWS, M3 X 12MM (10)	RUNDKOPFSCHRAUBEN, M3 X 12 MM (10)	VIS À TÊTE BOMBÉE, M3 X 12 MM (10)	VITI TESTA TONDA, M3X12 MM (10)
TLR234059	TURNBUCKLE, HD, 50MM (2): 22/22-4	SPANNSCHRAUBE, HD, 50 MM (2): 22/22-4	RIDOIR, ULTRARÉSISTANT, 50 MM (2) : 22/22-4	TENDITORE, HD, 50 MM (2): 22/22-4
TLR5964	FLATHEAD SCREW, M3 X 16MM (10)	FLACHKOPFSCHRAUBE, M3 X 16MM (10)	VIS À TÊTE PLATE, M3×16 MM (10)	VITI TESTA PIANA, M3X16 MM (10)
TLR5911	BUTTON HEAD SCREWS, M3 X 20MM (10)	RUNDKOPFSCHRAUBEN, M3 X 20 MM (10)	VIS À TÊTE BOMBÉE, M3 X 20 MM (10)	VITI TESTA TONDA, M3X20 MM (10)
TLR235008	FLAT HEAD SCREWS, M3 X 6MM (10)	RUNDKOPFSCHRAUBEN, M3 X 6 MM (10)	VIS À TÊTE PLATE, M3 X 6 MM (10)	VITI TESTA PIANA, M3X6 MM (10)
TLR235007	FLAT HEAD SCREWS, M2.5 X 10MM (10)	FLACHKOPFSCHRAUBEN, M2,5 X 10 MM (10)	VIS À TÊTE PLATE, M2,5 X 10MM (10)	VITI TESTA PIANA, M2.5X10 MM (10)
TLR6313	LOCKNUT, M3 X .5 X 5.5MM (10)	KONTERMUTTER, M3 X 0,5 X 5,5 MM (10)	CONTRE-ÉCROU, M3×0,5×5,5 MM (10)	CONTRODADI M3X0,5X5,5 MM (10)
TLR245012	BUTTON HEAD SCREWS, M2.5X4MM (10)	RUNDKOPFSCHRAUBEN, M2,5 X 4 MM (10)	VIS À TÊTE BOMBÉE, M2,5 X 4 MM (10)	VITI TESTA TONDA, M2.5X4 MM (10)
TLR6352	WASHERS, M3 (10)	UNTERLEGSCHLEIBEN, M3 (10)	RONDELLES, M3 (10)	RONDELLE, M3 (10)
TLR5913	BUTTON HEAD SCREWS, M2.5 X 12MM (10)	RUNDKOPFSCHRAUBEN, M2,5 X 12 MM (10)	VIS À TÊTE BOMBÉE, M2.5 X 12MM (10)	VITI TESTA TONDA, M2.5X12 MM (10)

#	DESCRIPTION	BESCHREIBUNG	DESCRIPTION	DESCRIZIONE
TLR5903	BUTTON HEAD SCREWS, M3 X 10MM (10)	RUNDKOPFSCHRAUBEN, M3 X 10 MM (10)	VIS À TÊTE BOMBÉE, M3 X 10 MM (10)	VITI TESTA TONDA, M3X10 MM (10)
TLR5910	BUTTON HEAD SCREWS, M3 X 14MM (10)	RUNDKOPFSCHRAUBEN, M3 X 14 MM (10)	VIS À TÊTE BOMBÉE, M3 X 14 MM (10)	VITI TESTA TONDA, M3X14 MM (10)
TLR6025	BALL STUD, 4.8MM X 6MM (4): 22	KUGELZAPFEN, 4,8 MM X 6 MM (4): 22	PITON À ROTULE, 4,8 MM X 6 MM (4) : 22	VITI A SFERA, 4,8X6 MM (4): 22
TLR72003	SHOCK TOOLS, COMPOSITE: ALL 22	STOSSDÄMPFERWERKZEUG, VERBUNDWERKSTOFF: ALLE 22	OUTILS D'AMORTISSEUR, COMPOSITES: TOUT 22	UTENSILI AMM., COMPOSITO: TUTTI I 22
TLR5961	FLATHEAD SCREWS, M3 X 8MM (10)	FLACHKOPFSCHRAUBEN, M3 X 8 MM (10)	VIS À TÊTE PLATE, M3X8 MM (10)	VITI TESTA PIANA, M3X8 MM (10)
TLR5901	BUTTON HEAD SCREWS, M3 X 6MM (10)	RUNDKOPFSCHRAUBEN, M3 X 6 MM (10)	VIS À TÊTE BOMBÉE, M3 X 6MM (10)	VITI TESTA TONDA, M3X6 MM (10)
TLR5092	UPPER SHOCK BUSHING: 22 (4)	OBERES DÄMPFERLAGER: 22 (4)	BAGUE D'AMORTISSEURS SUPÉRIEURS : 22 (4)	BOCCOLE AMM. SUPERIORI: 22 (4)
LOS-2411	SHOCK SPRING CUP & COLLAR SET: 22S	STOSSDÄMPFER-FEDERTELLER- UND MANSCHETTENSATZ: 22S	ENSEMBLE DE COUPELLES DE RESSORT ET COLLIERS D'AMORTISSEUR : 22S	SET COLLARE A MOLLE AMM.: 22S
LOS-2412	SHOCK SET, FRONT, ASSEMBLED (2): 22S SPRINT	STOSSDÄMPFERSATZ, VORNE, MONTIERT (2): 22S SPRINT	ENSEMBLE D'AMORTISSEURS, AVANT, ASSEMBLÉS (2) : 22S SPRINT	SET AMM., ANTERIORI, ASSEMBLATI (2): 22S SPRINT
LOS-2431	GEAR COVER: 22S	FAHRWERKABDECKUNG: 22S	CACHE D'ENGRENAGE : 22S	CARTER INGR.: 22S
LOS-2426	SHOCK TOWER SET: 22S SPRINT	STOSSDÄMPFERBRÜCKENSATZ: 22S SPRINT	ENSEMBLE DE TOUR D'AMORTISSEUR : 22S SPRINT	SET TORRE AMM.: 22S SPRINT
LOS-2433	TRANSMISSION CASE: 22S SPRINT	GETRIEBEABDECKUNG: 22S SPRINT	BOÎTIER DE TRANSMISSION : 22S SPRINT	SCATOLA DEL CAMBIO: 22S SPRINT
LOS-2400	CAMBER BLOCK & BULK HEAD SET: 22S SPRINT	RADSTURZBLOCK- UND KUGELKOPFSATZ: 22S SPRINT	ENSEMBLE DE CALES DE CARROSSAGE ET CLOISONS : 22S SPRINT	SET BLOCCO CAMBER E PARATIA: 22S SPRINT
LOS-2422	SHOCK SHAFT SET (44MM): 22S SPRINT	KOLBENSTANGENSATZ (44 MM): 22S SPRINT	ENSEMBLE DE BRAS D'AMORTISSEUR (44 MM) : 22S SPRINT	SET ALBERO AMM. (44 MM): 22S SPRINT
LOS-2417	BATTERY TRAY SET: 22S SPRINT	AKKUFACH-SATZ: 22S SPRINT	ENSEMBLE SUPPORT DE BATTERIE : 22S SPRINT	SET VASSOIO BATTERIA: 22S SPRINT
LOS-2421	BATTERY STRAP SET: 22S SPRINT	AKKU-KLEMMEN-SATZ: 22S SPRINT	ENSEMBLE DE SANGLES DE BATTERIE : 22S SPRINT	SET FASCETTE BATTERIA: 22S SPRINT
LOS-2402	HUB & SPINDLE SET: 22S SPRINT	NABEN- UND SPINDEL-SATZ: 22S SPRINT	ENSEMBLE MOYEU ET AXE : 22S SPRINT	SET MOZZO E FUSELLI: 22S SPRINT
LOS-2414	CVA DRIVESHAFT COMPLETE (67MM): 22S SPRINT	CVA-ANTRIEBSWELLE, KOMPLETT (67 MM): 22S SPRINT	ARBRE DE TRANSMISSION CVA, COMPLET (67 MM) : 22S SPRINT	ALBERO DI TRASMISSIONE CVA COMPLETO (67 MM): 22S SPRINT
LOS-2432	BODY/CAGE MOUNT SET: 22S SPRINT	KAROSSERIE/KÄFIG HALTERUNGSSATZ: 22S SPRINT	ENSEMBLE DE MONTAGE DE CARROSSERIE/CAGE : 22S SPRINT	SET SUPPORTI CARROZZERIA/GABBIA: 22S SPRINT
LOS-2413	CHASSIS BRACE SET: 22S SPRINT	KAROSSERIESTREBENSATZ: 22S SPRINT	ENSEMBLE DE SUPPORT DE CARROSSERIE : 22S SPRINT	SET BRETELLA TELAIO: 22S SPRINT
LOS-2398	CAMBER & STEERING LINK SET: 22S SPRINT	SATZ AUS STURZ UND LENKSTANGE: 22S SPRINT	ENSEMBLE BRAS DE DIRECTION ET CARROSSAGE : 22S SPRINT	SET CAMBER E BRACCETTI STERZO: 22S SPRINT

#	DESCRIPTION	BESCHREIBUNG	DESCRIPTION	DESCRIZIONE
LOS-2408	HINGE PIN SET: 22S SPRINT	SCHARNIERBOLZEN SATZ: 22S SPRINT	ENSEMBLE DE GOUPILLES DE CHARNIÈRE : 22S SPRINT	SET PERNO ARTICOLAZIONE: 22S SPRINT
LOS-2407	CASTER BLOCK SET: 22S SPRINT	RADBLOCKSATZ: 22S SPRINT	ENSEMBLE BLOC DE ROULETTES : 22S SPRINT	SET BLOCCO CASTER: 22S SPRINT
LOS-2415	SHOCK BODY SET: 22S SPRINT	STOSSDÄMPFERGEHÄUSESATZ: 22S SPRINT	ENSEMBLE DE CARROSSERIE D'AMORTISSEUR : 22S SPRINT	SET CORPO AMM.: 22S SPRINT
LOS-2427	BUMPER SET, CHROME: 22S SPRINT	STOSSSTANGENSATZ, CHROM: 22S SPRINT	ENSEMBLE DE PARE-CHOCS, CHROMÉ : 22S SPRINT	SET PARAURTI, CROMATO: 22S SPRINT
LOS-2410	BUMPER MOUNT SET: 22S SPRINT	STOSSSTANGENHALTERUNGSSATZ: 22S SPRINT	ENSEMBLE DE MONTAGE DE PARE-CHOCS : 22S SPRINT	SET MONTAGGIO PARAURTI: 22S SPRINT
LOS-2416	SUSPENSION ARM SET: 22S SPRINT	AUFHÄNGUNGSARMSATZ: 22S SPRINT	ENSEMBLE DE BRAS DE SUSPENSION : 22S SPRINT	SET BRACCETTI SOSPENSIONI: 22S SPRINT
LOS-2393	SERVO SAVER: 22S SPRINT	SERVO SAVER: 22S SPRINT	ÉCONOMISEUR DE SERVO : 22S SPRINT	SALVA SERVO: 22S SPRINT
LOS-2399	BELL CRANK SET: 22S SPRINT	WINKELHEBELSATZ: 22S SPRINT	ENSEMBLE DE LEVIER COUDÉ : 22S SPRINT	SET BIELLA A CAMPANA: 22S SPRINT
LOS-2423	FRONT WING MOUNT SET, BLACK: 22S SPRINT	SATZ VORDERE FLÜGELHALTERUNG, SCHWARZ: 22S SPRINT	ENSEMBLE DE MONTAGE D'AILES AVANT, NOIR : 22S SPRINT	SET MONTAGGIO ALA ANTERIORE, NERO: 22S SPRINT
LOS-2428	TOP WING MOUNT SET, BLACK: 22S SPRINT	SATZ OBERE FLÜGELHALTERUNG, SCHWARZ: 22S SPRINT	ENSEMBLE DE MONTAGE D'AILES SUPÉRIEURES, NOIR : 22S SPRINT	SET MONTAGGIO ALA SUPERIORE, NERO: 22S SPRINT
LOS-2429	INTERIOR & SEAT SET: 22S SPRINT	SATZ INNENRAUM UND SITZ: 22S SPRINT	ENSEMBLE SIÈGE ET INTÉRIEUR : 22S SPRINT	KIT SEDILE E INTERNI: 22S SPRINT
LOS-2424	CAGE SET, BLACK: 22S SPRINT	ÜBERROLLKÄFIGSET, SCHWARZ: 22S SPRINT	ENSEMBLE DE CAGES, NOIR : 22S SPRINT	SET SCOCCA, NERO: 22S SPRINT
LOS-2430	FRONT TIRE SET, MOUNTED, SOFT: 22S SPRINT	VORDERRADREIFENSATZ, MONTIERT, WEICH: 22S SPRINT	ENSEMBLE DE PNEUS AVANT, MONTÉS, TENDRES : 22S SPRINT	SET RUOTE ANTERIORI, MONTATE, MORBIDE: 22S SPRINT
LOS-2419	SHOCK SET, REAR, ASSEMBLED (2): 22S SPRINT	STOSSDÄMPFERSATZ, HINTEN, MONTIERT (2): 22S SPRINT	ENSEMBLE D'AMORTISSEURS, ARRIÈRE, ASSEMBLÉS (2) : 22S SPRINT	SET AMM., POSTERIORI, ASSEMBLATI (2): 22S SPRINT
LOS-2439	DRIVER FIGURE: 22S SPRINT	FAHRERFIGUR: 22S SPRINT	FIGURINE DE PILOTE : 22S SPRINT	MINIATURA DEL PILOTA: 22S SPRINT
LOS-2442	REAR TIRE SET, MOUNTED, SOFT: 22S SPRINT	HINTERRADREIFENSATZ, MONTIERT, WEICH: 22S SPRINT	ENSEMBLE DE PNEUS ARRIÈRE, MONTÉS, TENDRES : 22S SPRINT	SET RUOTE POSTERIORI, MONTATE, MORBIDE: 22S SPRINT
LOS-2435	MOTOR PLATE: 22S SPRINT	MOTORPLATTE: 22S SPRINT	PLAQUE MOTEUR : 22S SPRINT	PIASTRA MOTORE: 22S SPRINT
LOS-2434	CHASSIS, ALUMINUM: 22S SPRINT	FAHRGESTELL, ALUMINIUM: 22S SPRINT	CHÂSSIS, ALUMINIUM : 22S SPRINT	TELAIO, ALLUMINIO: 22S SPRINT
LOS-2437	WHEEL HEX SET: 22S SPRINT	SECHSKANTRADSATZ: 22S SPRINT	ENSEMBLE D'ÉCROUS HEXAGONAUX POUR ROUES : 22S SPRINT	SET ESAGONI CERCHI: 22S SPRINT
LOS-2436	PIVOT SET: 22S SPRINT	DREHGELENKSATZ: 22S SPRINT	ENSEMBLE DE PIVOTS : 22S SPRINT	SET PIVOT: 22S SPRINT
LOS-2440	HEADER SET, BLUE STEEL: 22S SPRINT	HEADER-SATZ, STAHLBLAU: 22S SPRINT	ENSEMBLE DE COLLECTEURS, ACIER BLEU : 22S SPRINT	SET TESTATE, ACCIAIO BLU: 22S SPRINT
LOS-2441	DETAIL SET: 22S SPRINT	DETAILSATZ: 22S SPRINT	ENSEMBLE DE DÉTAILS: 22S SPRINT	SET DETTAGLI: 22S SPRINT
SPMXCA522	1PC. BATTERY ADAPTER: IC5 DEVICE/IC3 BATTERY (2)	1 STK. AKKU-ADAPTER: IC5 GERÄT/IC3 AKKU (2)	ADAPTATEUR DE BATTERIE (1) : DISPOSITIF IC5/ BATTERIE IC3 (2)	1 PZ. ADATTATORE BATTERIA: IC5 DISPOSITIVO/IC3 BATTERIA (2)

#	DESCRIPTION	BESCHREIBUNG	DESCRIPTION	DESCRIZIONE
LOS-1888	BODY PANEL SET, BLACK: 22S SPRINT CAR	KAROSSERIETEILESATZ, SCHWARZ: 22S SPRINT CAR	ENSEMBLE DE PANNEAUX DE CARROSSERIE, NOIR : VOITURE 22S SPRINT	SET PANNELLI CARROZZERIA, NERO: 22S SPRINT CAR
LOS-1892	WING PANEL SET, BLACK: 22S SPRINT	TRAGFLÄCHENSATZ, SCHWARZ: 22S SPRINT	ENSEMBLE DE PANNEAUX D'AILE, NOIR : 22S SPRINT	SET PANNELLI ALI, NERO: 22S SPRINT
SPMX-1087	7.4V 4000MAH 2S 30C SMART LIPO G2 HARD CASE: IC5	7,4 V 4000 MAH 2S 30C SMART LIPO G2 HARD CASE: IC5	LI-PO SMART 7,4 V 4 000 MAH 2S 30C G2, BOÎTIER : IC5	7,4 V 4000 MAH 2S 30C SMART LIPO G2 HARD CASE: IC5
SPMXSM4800	FIRMA 3650 3300KV BL MOTOR: 22S	FIRMA 3650 3300 KV BL MOTOR: 22S	MOTEUR SANS BALAIS 3 300 KV FIRMA 3650 : 22S	MOTORE FIRMA 3650 3300 KV BL: 22S
SPMX-1106	FIRMA 45 BRUSHLESS SMART LITE ESC	FIRMA 45 BÜRSTENLOSER SMART-LITE-GESCHWINDIGKEITSREGLER	VARIATEUR ESC SMART LITE SANS BALAIS 45 A FIRMA	FIRMA 45 BRUSHLESS SMART LITE ESC
SPMS684	S684 HIGH SPEED METAL GEAR SERVO 25T	S684 HOCHGESCHWINDIGKEITS-METALLGETRIEBE-SERVO 25T	SERVO À ENGRENAGES MÉTALLIQUES HAUTE VITESSE 25T S684	S684 SERVO INGR. METALLO ALTA VELOCITÀ 25T

## RECOMMENDED PARTS | EMPFOHLENE TEILE | PIÈCES RECOMMANDÉES | PARTI CONSIGLIATE

#	DESCRIPTION	BESCHREIBUNG	DESCRIPTION	DESCRIZIONE
SPMPSS200	Smart Powerstage: 5000mAh 2S LiPo & S155 Charger	Smart Powerstage: 5000 mAh 2S LiPo & S155 Ladegerät	Smart Powerstage : Li-Po 5 000 mAh 2S et chargeur S155	Smart Powerstage: 5000 mAh 2S LiPo & Caricabatterie S155
SPMX-1032	Smart Powerstage Surface Bundle: 5000mAh 2S 50C LiPo Battery (IC5) / 100W S100 Charger	Smart Oberflächen-Leistungsteilpaket: 5000 mAh 2S 50C LiPo Akku (IC5) / 100 W S100 Ladegerät	Ensemble de surface Smart Powerstage : Batterie Li-Po 5 000 mAh 2S 50C (IC5) / chargeur 100 W S100	Smart Powerstage Surface Bundle: Batteria 5000 mAh 2S 50C LiPo (IC5) / Caricabatterie 100 W S100

## OPTIONAL PARTS | OPTIONALE TEILE | PIÈCES FACULTATIVES | PARTI OPZIONALI

#	DESCRIPTION	BESCHREIBUNG	DESCRIPTION	DESCRIZIONE
DYN2902	Machined Hex Driver, Red: 2.5mm	Gefräster Sechskantschlüssel, Rot: 2,5 mm	Tournevis pour vis à six pans usiné, rouge : 2,5 mm	Cacciavite esagonale lavorato, rosso: 2,5 mm
DYN2901	Machined Hex Driver, Red: 2.0mm	Gefräster Sechskantschlüssel, Rot: 2,0 mm	Tournevis pour vis à six pans usiné, rouge : 2,0 mm	Cacciavite esagonale lavorato, rosso: 2,0 mm
DYN2900	Machined Hex Driver, Red: 1.5mm	Gefräster Sechskantschlüssel, Rot: 1,5 mm	Tournevis pour vis à six pans usiné, rouge : 1,5 mm	Cacciavite esagonale lavorato, rosso: 1,5 mm
DYN2579	Dynamite 1/8, 1/10, 1/12 Pinion Caddy	Dynamite 1/8, 1/10, 1/12 Zahnrad Caddy	Boîtier de pignons Dynamite 1/8, 1/10, 1/12	Porta pignoni Dynamite 1/8, 1/10, 1/12
DYN2904	Machined Hex Driver Metric Set, Red	Bearbeiteter metrischer Sechskantschlüssel-Satz, Rot	Ensemble de tournevis pour vis à six pans usinés, rouge	Set cacciaviti esagonali metrici lavorati, rosso
DYNT1260	Shock Shaft Pliers/Multi-Tool	Kolbenstangenzange/Multifunktionswerkzeug	Pinces de bras d'amortisseurs/Outil multifonctions	Pinze multiutensili per alberi ammortizzatori
PRO8300203	1/10 Bald Eagle S3 Rear 2.2 Buggy Tires (2)	1/10 Bald Eagle S3 Heck 2.2 Buggy-Reifen (2)	Pneus pour buggy 2.2 arrière S3 Bald Eagle 1/10 (2)	Ruote 1/10 Bald Eagle S3 Posteriori 2.2 Buggy (2)
PRO829002	Hole Shot 3.0 2.2 2WD M3 Buggy Front Tires	Hole Shot 3.0 2.2 2WD M3 Buggy Vorderreifen	Pneus avant pour buggy M3 à deux roues motrices 3.0 2.2 Hole Shot	Ruote Shot 3.0 2.2 2WD M3 Buggy Anteriori
PRO8301203	1/10 Bald Eagle 2WD S3 Front 2.2 Buggy Tires (2)	1/10 Bald Eagle 2WD S3 Front 2.2 Buggy-Reifen (2)	Pneus pour buggy 2.2 avant S3 à deux roues motrices Bald Eagle 1/10 (2)	Ruote 1/10 Bald Eagle 2WD S3 Anteriori Front 2.2 Buggy (2)
PRO828202	Hole Shot 3.0 2.2 M3 Buggy Rear Tires	Hole Shot 3.0 2.2 M3 Buggy Hinterreifen	Pneus arrière pour buggy M3 3.0 2.2 Hole Shot	Ruote Shot 3.0 2.2 M3 Buggy Posteriori
LOS232038	Spur Gear & Slipper Pads, 48p, 84t: 22S	Stirnrad und Gleitkissen, 48p, 84T: 22S	Engrenage cylindrique et sabots de piston, 48P, 84T : 22S	Corona e pattini antisaltellamento 48P 84T: 22S
LOSA99201	Self-Stick Chassis Weight, 3 oz	Selbstklebendes Fahrgestell-Gewicht, 3 oz	Poids auto-adhésif pour châssis, 3 oz	Peso telaio autoadesivo, 3 once
PRO605802	Pro-Line Track Bag with Tool Holder	Pro-Line Track Bag mit Werkzeughalterung	Sac de piste Pro-Line avec porte-outil	Track Bag Pro-Line con portautensili
LOSA99174	Car Stand: 8IGHT/T	Fahrzeugständer: 8IGHT/T	Socle de voiture : 8IGHT/T	Supporto automodello: 8IGHT/T
PRO605803	Pro-Line Hauler Bag	Pro-Line Transporttasche	Sac de transport Pro-Line	Hauler Bag Pro-Line



#	DESCRIPTION	BESCHREIBUNG	DESCRIPTION	DESCRIZIONE
SPMXT2000	Tire Warmer: Off-road/ Drag racing	Reifenwärmer: Off-Road/ Drag-Racing	Chauffe-pneu : Course tout-terrain/dragster	Termocoperte: corse off-road/drag racing
SPMR5025	DX5 Pro DSMR TX Only	DX5 Pro DSMR nur TX	Émetteur DX5 Pro DSMR uniquement	DX5 Pro DSMR Solo TX
SPMXCA400	Smart Lipo Bag, 14 x 6.5 x 8 cm	Smart LiPo Ladetasche 14 x 6,5 x 8 cm	Sac Li-Po Smart 14 x 6,5 x 8 cm	Borsa Smart LiPo 14 x 6,5 x 8 cm
SPMXCA329	Pro Series Race 2s Charge Cable: IC3/5mm 2'	Pro Series Race 2s-Ladekabel: IC3/5mm 2'	Câble de charge Pro Series Race 2s : IC3/5 mm 2'	Cavo di ricarica Pro Series Race 2s: IC3/5mm 60 cm
SPMSR315	SR315 DSMR 3 CH Receiver	SR315 DSMR 3-Kanal-Empfänger	Récepteur SR315 DSMR 3 canaux	Ricevitore SR315 DSMR 3 CH
SPMX52S120HT	5000mAh 2S 7.6V Smart Pro Race HV LiPo 120C: 5mm	5000 mAh 2S 7,6 V Smart Pro Race HV LiPo 120C: 5 mm	Batterie haute tension Smart Pro Race 7,6 V 2S 5 000 mAh 120C : 5 mm	5000 mAh 2S 7,6 V Smart Pro Race HV LiPo 120C: 5 mm
SPMSS6245	S6245 High Speed/Torque Servo	S6245 Hochgeschwindigkeitsservo mit hohem Drehmoment	Servo de couple/haute vitesse S6245	S6245 Servo Alta Velocità/ Coppia
SPMSR515	SR515 DSMR 5 CH Receiver	SR515 DSMR 5-Kanal-Empfänger	Récepteur SR515 DSMR 5 canaux	Ricevitore SR515 DSMR 5 CH
SPMSS6240	S6240 High Torq High Speed Digital WP Metal Servo	S6240 Digitaler WP-Metallservo mit hohem Drehmoment und hoher Geschwindigkeit	Servo métallique numérique étanche à vitesse et couple élevés S6240	S6240 Servo metallo WP digitale alta velocità alta coppia
SPMSS6230	S6230 Ultra Torq Mid Speed Digital WP Metal Servo	S6230 Digitaler WP-Kunststoff-Servo mit extra hohem Drehmoment und mittlerer Geschwindigkeit	Servo métallique étanche numérique à vitesse moyenne et couple élevé S6230	S6230 Servo metallo WP digitale media velocità ultra coppia
SPMSR2100	SR2100 DSMR Micro Race Rx Antenna-Less	SR2100 DSMR Micro Race Rx ohne Antenne	Récepteur DSMR Micro Race SR2100 sans antenne	SR2100 DSMR Micro Race Rx senza antenna
PRO273602	R Velocity 2.2 Hex Whl,Yel: LOS22, 12mm Hex B4.1	R Velocity 2.2 Sechskantaufnahme, Gelb: LOS22, 12 mm Sechskant B4.1	Roue hexagonale arrière Velocity 2.2, jaune : Hexagonale B4.1 12 mm, LOS22	Esagono cerchio R Velocity 2.2, giallo: LOS22, esag. 12 mm B4.1
SPMX632S120HT	6300mAh 2S 7.6V Smart Pro Race HV LiPo 120C: 5mm	6300 mAh 2S 7,6 V Smart Pro Race HV LiPo 120C: 5 mm	Batterie haute tension Smart Pro Race 7,6 V 2S 6 300 mAh 120C : 5 mm	6300 mAh 2S 7,6 V Smart Pro Race HV LiPo 120C: 5 mm
SPMXC2020	Smart S1200 G2 AC Charger; 1x200W	Smart S1200 G2 Wechselstrom-Ladegerät; 1x200W	Chargeur Smart CA S1200 G2, 1 x 200 W	Caricabatterie Smart S1200 G2 CA, 1x200 W
SPMXC2000	Smart S2100 G2 AC Charger; 2x100W	Smart S2100 G2 AC-Ladegerät, 2x100W	Chargeur c.a. G2 Smart S2100, 2 x 100 W	Caricabatterie Smart S2100 G2 CA, 2x100 W
SPMX412S120HT	4100mAh 2S 7.6V Smart Pro Race HV LiPo 120C: 5mm	4100 mAh 2S 7,6 V Smart Pro Race HV LiPo 120C: 5 mm	Batterie haute tension Smart Pro Race 7,6 V 2S 4 100 mAh 120C : 5 mm	4100 mAh 2S 7,6 V Smart Pro Race HV LiPo 120C: 5 mm
SPMXC2010	Smart S2200 G2 AC Charger, 2x200W	Smart S2200 G2 Wechselstrom-Ladegerät, 2x200 W	Chargeur c.a. G2 S2200 Smart, 2 x 200 W	Caricabatterie Smart S2200 G2 CA, 2x200 W
PRO276804	Velocity 2.2 4WD Front White Wheel (2): B64	Velocity 2.2 4WD Weißes Vorderrad (2): B64	Roue avant blanche Velocity 2.2 à 4 roues motrices (2) : B64	Cerchi Velocity 2.2 4WD Anteriori Bianco (2): B64
SPM6420	iXSR Surface Transmitter with SR515 Receiver	iXSR-Oberflächensender mit SR515-Empfänger	Émetteur de surface iXSR avec récepteur SR515	Trasmittente di superficie iXSR con Ricevitore SR515
SPM5025	DX5 Pro DSMR TX w/SR2100	DX5 Pro DSMR TX mit SR2100	Émetteur DSMR DX5 Pro avec SR2100	DX5 Pro DSMR TX con R2100
TLR332024	Pinion Gear 24T, 48P, AL	Zahnradgetriebe 24T, 48P, AL	Engrenage à pignons 24T, 48P, en aluminium	Pignone 24T, 48P, AL
TLR332018	Pinion Gear 18T, 48P, AL	Zahnradgetriebe 18T, 48P, AL	Engrenage à pignons 18T, 48P, en aluminium	Pignone 18T, 48P, AL
TLR332017	Pinion Gear 17T, 48P, AL	Zahnradgetriebe 17T, 48P, AL	Engrenage à pignons 17T, 48P, en aluminium	Pignone 17T, 48P, AL
TLR332029	Pinion Gear 29T, 48P, AL	Zahnradgetriebe 29T, 48P, AL	Engrenage à pignons 29T, 48P, en aluminium	Pignone 29T, 48P, AL
TLR334052	HD Turnbuckle Kit, Titanium: 22 5.0	HD-Spannschrauben-Satz, Titan: 22 5.0	Ensemble de ridoirs ultrarésistants, en titane : 22 5.0	Kit tenditore HD, titanio: 22 5.0
TLR332023	Pinion Gear 23T, 48P, AL	Zahnradgetriebe 23T, 48P, AL	Engrenage à pignons 23T, 48P, en aluminium	Pignone 23T, 48P, AL
TLR336002	TLR 22 Series Hardware Box, Metric: 22/T/SCT/22-4	TLR 22 Serie Hardware Box, Metrisch: 22/T/SCT/22-4	Boîte de matériel série TLR 22, métrique : 22/T/SCT/22-4	Scatola bulloneria serie TLR 22, metrica: 22/T/SCT/22-4
TLR332026	Pinion Gear 26T, 48P, AL	Zahnradgetriebe 26T, 48P, AL	Engrenage à pignons 26T, 48P, en aluminium	Pignone 26T, 48P, AL

#	DESCRIPTION	BESCHREIBUNG	DESCRIPTION	DESCRIZIONE
TLR332073	VHA Rear Axle, Buggy (2): 22 5.0	VHA Hinterachse, Buggy (2): 22 5.0	Essieu arrière VHA, Buggy (2) : 22 5.0	Assale posteriore VHA, buggy (2): 22 5.0
TLR332019	Pinion Gear 19T, 48P, AL	Zahnradgetriebe 19T, 48P, AL	Engrenage à pignons 19T, 48P, en aluminium	Pignone 19T, 48P, AL
TLR332021	Pinion Gear 21T, 48P, AL	Zahnradgetriebe 21T, 48P, AL	Engrenage à pignons 21T, 48P, en aluminium	Pignone 21T, 48P, AL
TLR332020	Pinion Gear 20T, 48P, AL	Zahnradgetriebe 20T, 48P, AL	Engrenage à pignons 20T, 48P, en aluminium	Pignone 20T, 48P, AL
TLR336010	Shock Standoff, Carbon Tower, Titanium (2): 22 5.0	Stoßdämpfer-Standoff, Karbon-Brücke, Titan (2): 22 5.0	Dispositif d'espacement d'amortisseur, tour en carbone, titane (2) : 22 5.0	Distanziale amm., torre carbonio, titanio (2): 22 5.0
TFE5919	Sealed Bearing Kit - TLR 22 5.0 SR	Satz Abgedichtete Lager - TLR 22 5.0 SR	Ensemble de roulements hermétiques - TLR 22 5.0 SR	Kit cuscinetti sigillati - TLR 22 5.0 SR
TLR332077	Aluminum Diff Cover, G2 Gear Diff: 22	Aluminium Differential-Abdeckung G2 Getriebedifferential: 22	Couvercle diff. en aluminium, engrenage différentiel G2 : 22	Coperchio diff. in alluminio, ingr. diff. G2: 22
TLR332043	Direct Drive System, Set: All 22	Direktantriebssystem, Satz: Alle 22	Ensemble système d'entraînement direct : Tout 22	Set sistema trasmissione diretta DDS: Tutti i 22
TLR332027	Pinion Gear 27T, 48P, AL	Zahnradgetriebe 27T, 48P, AL	Engrenage à pignons 27T, 48P, en aluminium	Pignone 27T, 48P, AL
TLR336001	4mm Aluminum Serrated Lock Nuts, Blue (6)	4 mm Aluminium Rändelmutter, blau (6)	Contre-écrous en aluminium à embase striée 4 mm, bleu (6)	Controdadi dentati in alluminio 4 mm, blu (6)
TLR332025	Pinion Gear 25T, 48P, AL	Zahnradgetriebe 25T, 48P, AL	Engrenage à pignons 25T, 48P, en aluminium	Pignone 25T, 48P, AL
TLR332028	Pinion Gear 28T, 48P, AL	Zahnradgetriebe 28T, 48P, AL	Engrenage à pignons 28T, 48P, en aluminium	Pignone 28T, 48P, AL
TLR232084	Grooved Slipper Plates, SHDS (2)	Gerillte Gleiterplatten, SHDS (2)	Plaques de sabot rainurées, sabot hautement résistant (2)	Piastre pattino scanalate, SHDS (2)
TLR232076	75T Spur Gear, SHDS, 48P	Stirnrad 75T, SHDS, 48P	Engrenage cylindrique 75T, sabot hautement résistant, 48P	Corona 75T, SHDS, 48P
TLR70007	TLR Team Foam Pit Mat, 24 x 68	TLR Team Schaumstoff-Boxenmatte, 24 x 68	Pit mat en mousse TLR Team, 24 x 68	Tappetino in schiuma TLR Team, 24x68
TLR233042	Machined Shock Pistons, 3 x 1.4mm, G3 (2)	Gefräste Stoßdämpferkolben, 3 x 1,4 mm, G3 (2)	Pistons amortisseurs usinés, 3 x 1,4 mm, G3 (2)	Pistoni amm. lavorati, 3x1,4 mm, G3 (2)
TLR232075	72T Spur Gear, SHDS, 48P	Stirnrad 72T, SHDS, 48P	Engrenage cylindrique 72T, sabot hautement résistant, 48P	Corona 72T, SHDS, 48P
TLR232000	Complete Ball Diff, Tungsten Balls: 22, 22T, 22SCT	Komplettes Kugel-Diff, Wolfram-Kugeln: 22, 22T, 22SCT	Différentiel de bille complet, billes de tungstène : 22, 22T, 22SCT	Sfera diff. complete, sfere di tungsteno: 22, 22T, 22SCT
TLR6031	Titanium Ball Stud, 4.8 x 8mm (2)22/22T	Kugelzapfen aus Titan, 4,8 x 8 mm (2)22/22T	Piton à rotule en titane, 4,8 x 8 mm (2)22/22T	Prigioniero a sfera in titanio 4,8x8 mm (2)22/22T
TLR77002	Shock O-ring Grease, 8cc	Stoßdämpfer O-Ring-Fett, 8cc	Graisse pour joint torique d'amortisseur, 8 cc	Grasso per O-ring degli ammortizzatori, 8 cm³
TLR77000	High-Pressure Black Grease, 8cc	Schwarzes Hochdruck-Schmierfett, 8cc	Graisse noire haute pression, 8 cc	Grasso nero ad alta pressione, 8 cm³
TLR232103	CVA Driveshaft Bones, X68mm (2): 22X	CVA-Antriebsknochen, X68 mm (2): 22X	Os de l'arbre de transmission CVA, 68 mm (2) : 22X	Dogbone albero trasmissione CVA, X68 mm (2): 22X
TLR233030	Spring Cup Set, G3 (4ea)	Federteller-Satz, G3 (je 4)	Ensemble de coupelles de ressorts, G3 (4ea)	Set scodellino molle, G3 (4 ciascuno)
TLR232082	Layshaft, Aluminum, SHDS	Zwischenwelle, Aluminium, SHDS	Arbre intermédiaire, aluminium, sabot hautement résistant	Albero secondario, alluminio, SHDS
TLR233035	Machined Shock Pistons, 2 x 1.5mm, G3 (2)	Gefräste Stoßdämpferkolben, 2 x 1,5 mm, G3 (2)	Pistons amortisseurs usinés, 2 x 1,5 mm, G3 (2)	Pistoni amm. lavorati 2x1,5 mm, G3 (2)
TLR232102	CVA Driveshaft Bones, X67mm (2): 22X	CVA-Antriebsknochen, X67 mm (2): 22X	Os de l'arbre de transmission CVA, 67 mm (2) : 22X	Dogbone albero trasmissione CVA, X67 mm (2): 22X
TLR2952	Silicone Diff Grease, 8cc: 22	Silikonfett für Diff., 8cc: 22	Graisse silicone pour différentiel, 8 cc : 22	Grasso diff. silicone, 8 cm³ : 22
TLR233036	Machined Shock Pistons, 2 x 1.6mm, G3 (2)	Gefräste Stoßdämpferkolben, 2 x 1,6 mm, G3 (2)	Pistons amortisseurs usinés, 2 x 1,6 mm, G3 (2)	Pistoni amm. lavorati 2x1,6 mm, G3 (2)
TLR332016	Pinion Gear 16T, 48P, AL	Zahnradgetriebe 16T, 48P, AL	Engrenage à pignons 16T, 48P, en aluminium	Pignone 16T, 48P, AL
TLR72000	Ball cup wrench, 4.8mm, 22/T/SCT	Kugelkopfschlüssel, 4,8 mm, 22/T/SCT	Clé pour cuvette de roulement à billes, 4,8 mm, 22/T/SCT	Chiave per attacco a sfera 4,8 mm, 22/T/SCT

#	DESCRIPTION	BESCHREIBUNG	DESCRIPTION	DESCRIZIONE
TLR233025	Shock Body, 36.5mm, G3 3mm (1)	Stoßdämpfergehäuse, 36,5 mm, G3 3 mm (1)	Corps d'amortisseur, 36,5 mm, G3 3 mm (1)	Scocca ammortizzatore 36,5 mm, G3 3 mm (1)
TLR232078	81T Spur Gear, SHDS, 48P	Stirnrad 81T, SHDS, 48P	Engrenage cylindrique 81T, sabot hautement résistant, 48P	Corona 81T, SHDS, 48P
TLR99102	Turnbuckle Wrench, 22,8B, 8T	Spannschraubenschlüssel, 22,8B, 8T	Clé de ridoir, 22, 8B, 8T	Chiave per tenditore, 22,8B, 8T
TLR232074	69T Spur Gear, SHDS, 48P	Stirnrad 69T, SHDS, 48P	Engrenage cylindrique 69T, sabot hautement résistant, 48P	Corona 69T, SHDS, 48P
TLR6030	Titanium Ball Stud, 4,8 x 6mm (2)	Titan-Kugelzapfen, 4,8 x 6 mm (2)	Piton à rotule, 4,8 x 6 mm, en titane (2)	Prigioniero a sfera 4,8x6 mm, titanio (2)
TLR232077	78T Spur Gear, SHDS, 48P	Stirnrad 78T, SHDS, 48P	Engrenage cylindrique 78T, sabot hautement résistant, 48P	Corona 78T, SHDS, 48P
TLR233031	Shock End Set, G3 (4ea)	Stoßdämpferendstück, Satz, G3 (je 4)	Ensemble d'extrémités d'amortisseurs, G3 (4ea)	Set terminale amm., G3 (4ea)
TLR233037	Machined Shock Pistons, 1.6-1.7 Split, G3 (2)	Gefräste Stoßdämpferkolben, 1,6-1,7 Split, G3 (2)	Pistons amortisseurs usinés, 1.6-1.7 partagés, G3 (2)	Pistoni amm. lavorati, 1,6-1,7 divisi, G3 (2)
TLR233062	Shock Travel Spacer Set: 22	Stoßdämpferhub-Distanzstücksatz: 22	Ensemble d'entretoise d'amortisseur de course : 22	Kit distanziali corsa ammortizzatori: 22
TLR-1064	Carbon Front Shock Tower: 22S Sprint	Vordere Kohlefasern-Stoßdämpferbrücke: 22S Sprint	Tour d'amortisseur avant en carbone : 22S Sprint	Torre amm. in carbonio, anteriore: 22S Sprint
TLR-1062	Spindle Set, Aluminum, Black: 22S Sprint	Spindel-Satz, Aluminium, Schwarz: 22S Sprint	Ensemble d'axes, aluminium, noir : 22S Sprint	Set fusi di sterzo, alluminio, nero: 22S Sprint
TLR-1055	Adjustable Pivot Set C & D, Black: 22S Sprint	Einstellbarer Drehgelenksatz C & D, Schwarz: 22S Sprint	Ensemble de pivots ajustables C et D, noir : 22S Sprint	Set pivot regolabile C & D, nero: 22S Sprint
TLR-1065	Carbon Fiber Chassis, 2.5mm: 22S Sprint	Carbonfaser-Karosserie, 2,5 mm: 22S Sprint	Châssis en fibre de carbone, 2,5 mm : 22S Sprint	Telaio in fibra di carbonio 2,5mm: 22S Sprint
TLR-1066	Front Pivot Block, Aluminum, Black: 22S Sprint	Vorderes Zapfenlager, Aluminium, Schwarz: 22S Sprint	Bloc pivot avant, en aluminium, noir : 22S Sprint	Blocco girevole anteriore, alluminio, nero: 22S Sprint
TLR-1063	Bell Crank Set, Aluminum, Black: 22S Sprint	Winkelhebel, Satz, Aluminium, schwarz: 22S Sprint	Ensemble de leviers coudés, en aluminium, noir : 22S Sprint	Set biella a campana, alluminio, nero: 22S Sprint
TLR-1054	Front Axle Set, Aluminum, Black, 12mm: 22S Sprint	Vorderachsensatz, Aluminium, Schwarz, 12 mm: 22S Sprint	Ensemble d'essieux avant, en aluminium, noir, 12 mm : 22S Sprint	Set assale anteriore, alluminio, nero, 12 mm: 22S Sprint
TLR-1068	Carbon Spindle Arm Tuning Set: 22S Sprint	Kohlefasern-Spindelarmsatz: 22S Sprint	Ensemble d'ajustement de bras d'axe en carbone : 22S Sprint	Set tuning bracci fuso in carbonio: 22S Sprint
TLR-1070	Caster Block Set, 5 Deg, Aluminum: 22S Sprint	Radbloksatz, 5 Grad, Aluminium: 22S Sprint	Ensemble de blocs de rondelles, 5 degrés, en aluminium : 22S Sprint	Set caster block, 5°, alluminio: 22S Sprint
TLR-1071	Motor Plate, Machined Aluminum, Black: 22S Sprint	Motorplatte, gefrästes Aluminium, Schwarz: 22S Sprint	Plaque moteur, en aluminium usiné, noir : 22S Sprint	Piastra motore, alluminio lavorato, nero: 22S Sprint
TLR-1067	Carbon Rear Shock Tower: 22S Sprint	Hintere Kohlefasern-Stoßdämpferbrücke: 22S Sprint	Tour d'amortisseur arrière en carbone : 22S Sprint	Torre amm. in carbonio, posteriore: 22S Sprint
TLR-1069	Caster Block Set, 0 Deg, Aluminum: 22S Sprint	Radbloksatz, 0 Grad, Aluminium: 22S Sprint	Ensemble de blocs de rondelles, 0 degrés, en aluminium : 22S Sprint	Set caster block, 0°, alluminio: 22S Sprint
LOS-1885	Spring Set, 4-8b (2): 22S Sprint	Federsatz, 4-8b (2): 22S Sprint	Ensemble de ressorts, 4-8 lb (2) : 22S Sprint	Set molle, 4-8b (2): 22S Sprint
LOS-1886	Front Arm Set, Stiffezel: 22S Sprint	Vorderarmsatz, Stiffezel: 22S Sprint	Bras avant, Stiffezel : 22S Sprint	Set braccio anteriore Stiffezel: 22S Sprint
LOS-1887	Rear Arm Set, Stiffezel: 22S Sprint	Hinterarmset, Stiffezel: 22S Sprint	Ensemble de bras arrière, Stiffezel : 22S Sprint	Set braccio posteriore, Stiffezel: 22S Sprint
LOS-1889	Body Panel Set, Silver: 22S Sprint	Karosserieteilesatz, Silber: 22S Sprint	Ensemble de panneaux de carrosserie, argenté : 22S Sprint	Set pannelli carrozzeria, argento: 22S Sprint
LOS-1890	Body Panel Set, White: 22S Sprint	Karosserieteilesatz, Weiß: 22S Sprint	Ensemble de panneaux de carrosserie, blanc : 22S Sprint	Set pannelli carrozzeria, bianco: 22S Sprint
LOS-1891	Body Panel Set, Red: 22S Sprint	Karosserieteilesatz, Rot: 22S Sprint	Ensemble de panneaux de carrosserie, rouge : 22S Sprint	Set pannelli carrozzeria, rosso: 22S Sprint
LOS-1893	Wing Panel Set, Silver: 22S Sprint	Tragflächen-Satz, Silber: 22S Sprint	Ensemble de panneaux d'aile, argenté : 22S Sprint	Set pannelli ala, argento: 22S Sprint
LOS-1894	Wing Panel Set, White: 22S Sprint	Tragflächen-Satz, Weiß: 22S Sprint	Ensemble de panneaux d'aile, blanc : 22S Sprint	Set pannelli ala, bianco: 22S Sprint

#	DESCRIPTION	BESCHREIBUNG	DESCRIPTION	DESCRIZIONE
LOS-1895	Wing Panel Set, Red: 22S Sprint	Tragflächen-Satz, Rot: 22S Sprint	Ensemble de panneaux d'aile, rouge : 22S Sprint	Set pannelli ala, rosso: 22S Sprint
LOS-1896	Header Set, Black Chrome: 22S Sprint	Header-Set, Schwarz-Chrom: 22S Sprint	Ensemble de collecteurs, noir chromé : 22S Sprint	Set testate, cromato nero: 22S Sprint
LOS-1897	Header Set, Matte Black: 22S Sprint	Header-Set, Schwarz matt: 22S Sprint	Ensemble de collecteurs, noir mat : 22S Sprint	Set testate, nero opaco: 22S Sprint
LOS-1898	Bumper Set, Black: 22S Sprint	Stoßstangensatz, Schwarz: 22S Sprint	Ensemble de pare-chocs, noir : 22S Sprint	Set paraurti, nero: 22S Sprint
TLR-1072	Rear Bulkhead, Aluminum, Black: 22S Sprint	Hintere Spritzwand, Aluminium, Schwarz: 22S Sprint	Cloison arrière, en aluminium, noire : 22S Sprint	Paratia posteriore, alluminio, nero: 22S Sprint
LOS-2418	FRONT TIRE SET, MOUNTED, HARD: 22S SPRINT	VORDERRADREIFENSATZ, MONTIERT, HART: 22S SPRINT	ENSEMBLE DE PNEUS AVANT, MONTÉS, DURS : 22S SPRINT	SET RUOTE ANTERIORI, MONTATE, RIGIDE: 22S SPRINT
LOS-2425	REAR TIRE SET, MOUNTED, HARD: 22S SPRINT	HINTERRADREIFENSATZ, MONTIERT, HART: 22S SPRINT	ENSEMBLE DE PNEUS ARRIÈRE, MONTÉS, DURS : 22S SPRINT	SET RUOTE POSTERIORI, MONTATE, RIGIDE: 22S SPRINT
LOS-2409	CAGE SET, WHITE: 22S SPRINT	ÜBERROLLKÄFIGSATZ, WEISS: 22S SPRINT	ENSEMBLE DE CAGES, BLANC : 22S SPRINT	SET GABBIA, BIANCO: 22S SPRINT
LOS-2404	FRONT WING MOUNT SET, WHITE: 22S SPRINT	SATZ VORDERE FLÜGELHALTERUNG, WEISS: 22S SPRINT	ENSEMBLE DE MONTAGE D'AILES AVANT, BLANC : 22S SPRINT	SET MONTAGGIO ALA ANTERIORE, BIANCO: 22S SPRINT
LOS-2420	TOP WING MOUNT SET, WHITE: 22S SPRINT	SATZ OBERE FLÜGELHALTERUNG, WEISS: 22S SPRINT	ENSEMBLE DE MONTAGE D'AILES SUPÉRIEURES, BLANC : 22S SPRINT	SET MONTAGGIO ALA SUPERIORE, BIANCO: 22S SPRINT
TLR336003	M4 ALUMINUM SERRATED NUTS, LOW PROFILE, BLACK (4)	M4-ALUMINIUM-KERBZAHNMÜTTERN, NIEDRIGPROFIL, SCHWARZ (4)	ÉCROUS EN ALUMINIUM À EMBASE STRIÉE M4, PROFIL BAS, NOIRS (4)	DADI SEGHETTATI ALLUMINIO M4, BASSO PROFILO, NERO (4)
LOS-2604	SPRING SET, 9-14LB (2): 22S SPRINT	FEDERSATZ, 9-14LB (2): 22S SPRINT	ENSEMBLE DE RESSORTS, 9-14 LB (2) : 22S SPRINT	SET MOLLE, 9-14 LIBBRE (2): 22S SPRINT



